

# SUNSHINE COAST 4 Bedroom / 259.34 m<sup>2</sup> **BUILD** *Homes*



HOUSE DESIGN-SUNSHINE COAST

# SUNSHINE COAST

4 Bedroom / 259.34 m<sup>2</sup>

**BUILD**<sup>TM</sup>  
Homes



HOUSE DESIGN-SUNSHINE COAST

# SUNSHINE COAST 4 Bedroom / 259.34 m<sup>2</sup>

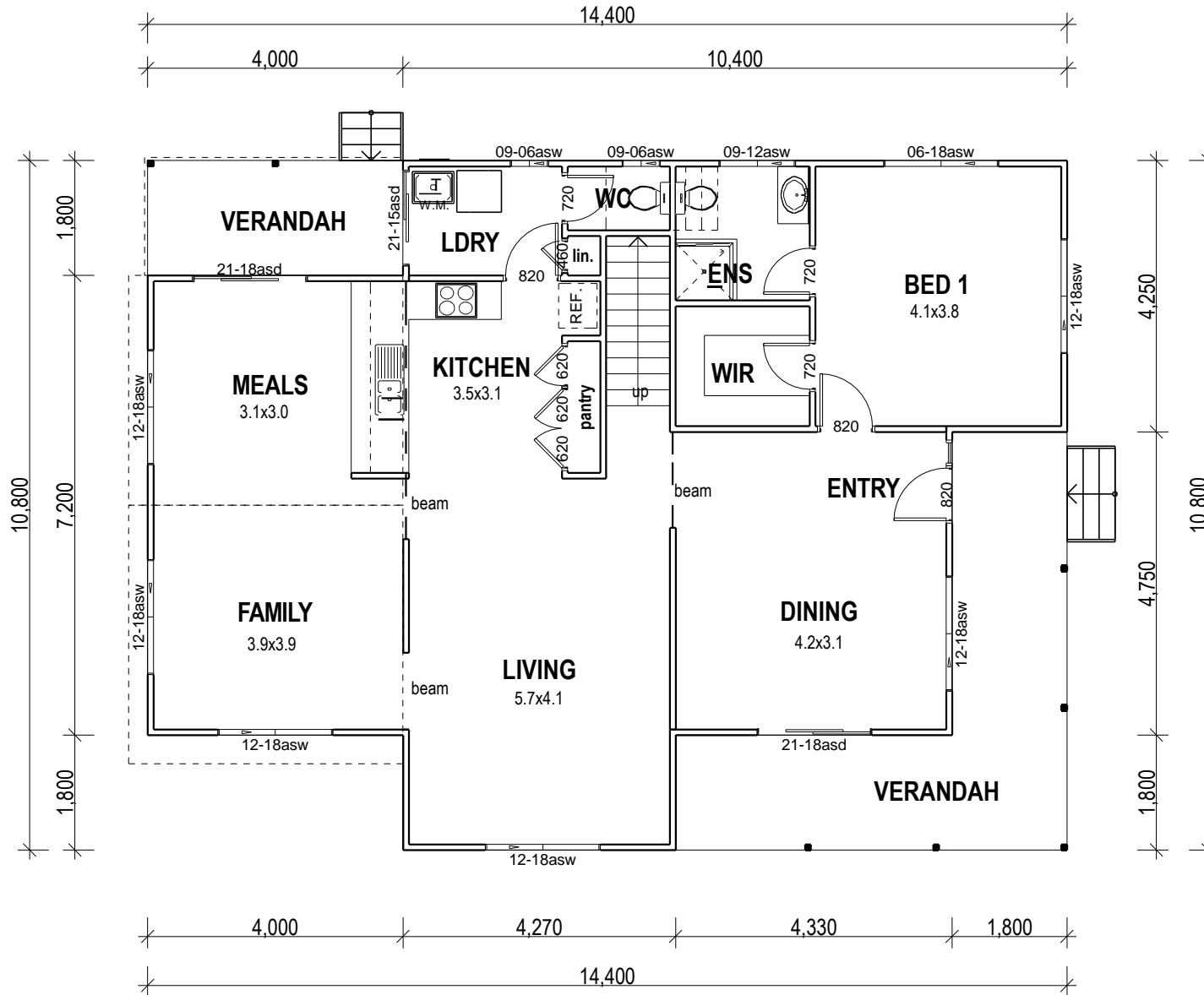

LOWER FLOOR AREAS:	
LIVING:	120.83 Sq.m
VERANDAHS:	26.19 Sq.m
UPPER FLOOR AREAS:	
LIVING:	92.74 Sq.m
VERANDAH:	19.58 Sq.m
TOTAL AREA:	259.34 Sq.m
	27.913 Sq

**LOWER FLOOR PLAN**

# SUNSHINE COAST 4 Bedroom / 259.34 m<sup>2</sup>

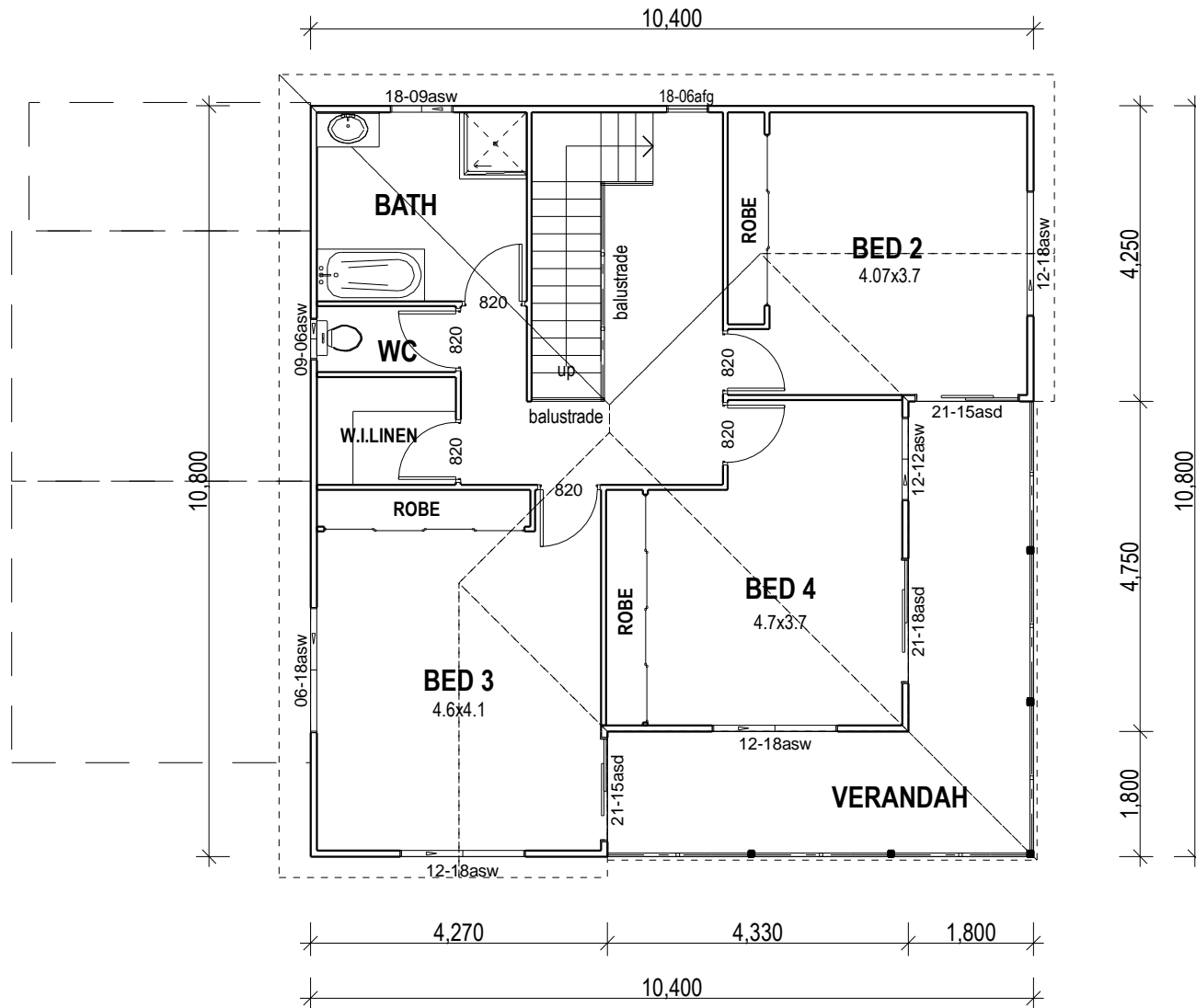

**UPPER FLOOR PLAN**

# Thank you for your Attention !

For more information, please visit <http://www.i-build.com.au>  
contact us on [info@i-build.com.au](mailto:info@i-build.com.au)



<http://i-build.com.au/>



<http://facebook.com/ibuildau/>



<http://pinterest.com/ibuildbuildings/>



<http://youtube.com/user/ibuildbuilding>



<http://plus.google.com/+I-buildAu/>