



STRONGER



SMARTER



CHEAPER



## CASA BIANCA

2 Bedrooms / 84.97m<sup>2</sup>

Living Area	72.25m <sup>2</sup>
Verandah Area	12.72m <sup>2</sup>
Total Area	84.97m <sup>2</sup>

For singles, retirees, first home owners or investors, the Casa Bianca is compact, while affording comfortable living areas. The kitchen opening onto the deck makes for easy access to alfresco dining.

### Floor Plan

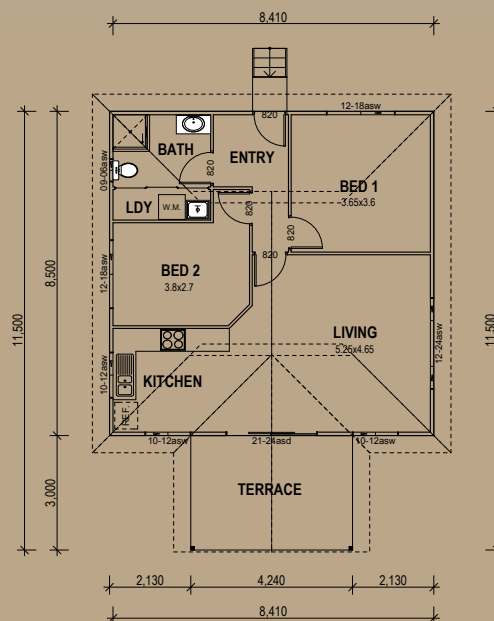

5A Hartnett Close, Mulgrave, VIC  
 PO Box 2516, Mt Waverley, VIC 3149  
 1800 679 268

Web: [i-build.com.au](http://i-build.com.au) email: [info@i-build.com.au](mailto:info@i-build.com.au)