



STRONGER



SMARTER



CHEAPER



## GEELONG

4 Bedrooms / 157.08m<sup>2</sup>

Living Area	144.84m <sup>2</sup>
Verandah Area	12.24m <sup>2</sup>
Total Area	157.08m <sup>2</sup>

The neat front of the charming Geelong belies the spacious day rooms inside. With four bedrooms, large living, separate dining and family rooms the Geelong is perfect for the growing family.

### Floor Plan

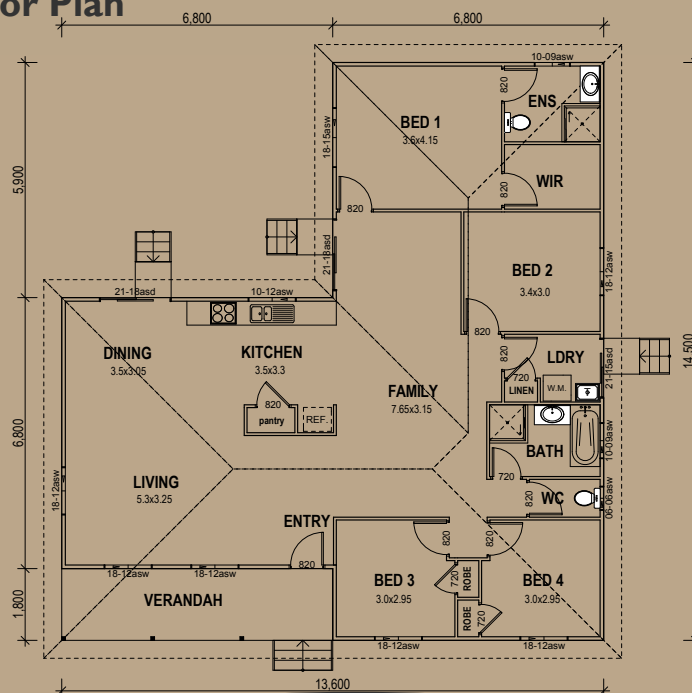

5A Hartnett Close, Mulgrave, VIC  
 PO Box 2516, Mt Waverley, VIC 3149  
 1800 679 268

Web: [i-build.com.au](http://i-build.com.au) email: [info@i-build.com.au](mailto:info@i-build.com.au)