



STRONGER



SMARTER



CHEAPER



## PORTLAND

2 Bedrooms / 45.00m<sup>2</sup>

Living Area	36.84m <sup>2</sup>
Verandah Area	8.16m <sup>2</sup>
Total Area	45.00m <sup>2</sup>

If you're looking for neat and compact, the Portland is for you. Ideal as a fishing lodge, art studio, holiday cabin or a parent retreat, the Portland will catch the breezes and show you amazing views.

### Floor Plan

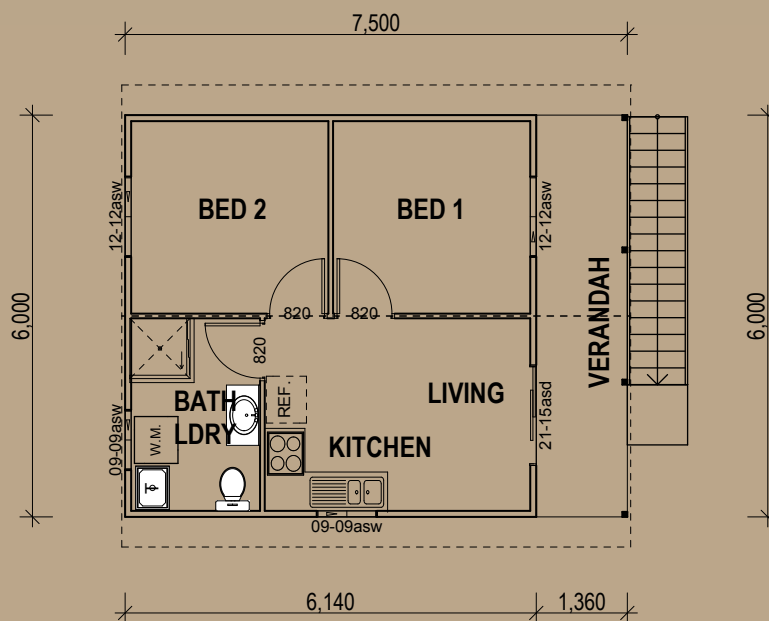

5A Hartnett Close, Mulgrave, VIC  
 PO Box 2516, Mt Waverley, VIC 3149  
 1800 679 268

Web: [i-build.com.au](http://i-build.com.au) email: [info@i-build.com.au](mailto:info@i-build.com.au)