



STRONGER



SMARTER



CHEAPER



SAN REMO

4 Bedrooms / 221.31m²

Living Area	179.7m ²
Verandah Area	4.34m ²
Total Area	221.31m ²

Four large bedrooms and central living areas make the San Remo ideal for family living. With its covered entrance and access from the garage, your family will return home safe and dry.

Floor Plan

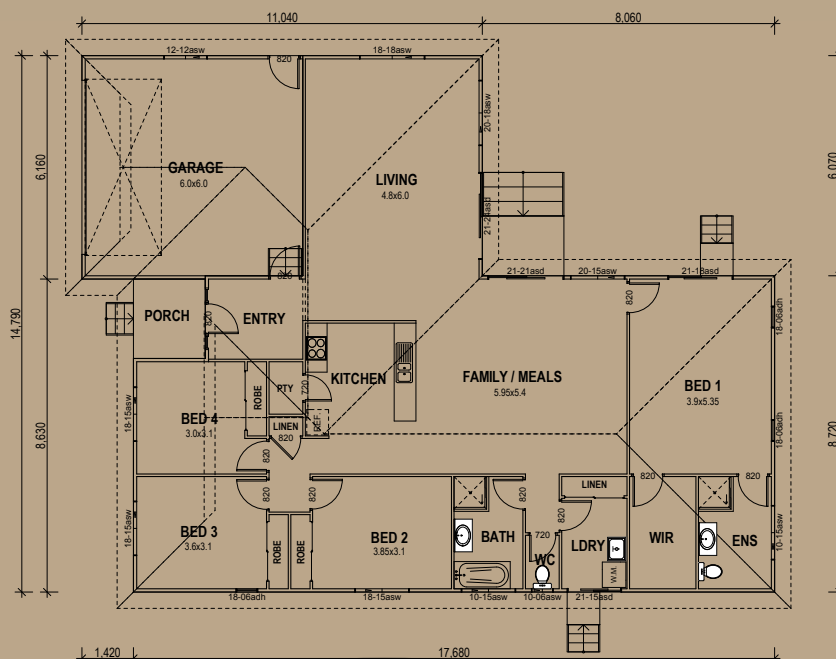

5A Hartnett Close, Mulgrave, VIC
 PO Box 2516, Mt Waverley, VIC 3149
 1800 679 268

Web: i-build.com.au email: info@i-build.com.au