



STRONGER



SMARTER



CHEAPER



## WESTWOOD

2 Bedrooms / 151.20m<sup>2</sup>

Living Area	75.60m <sup>2</sup>
Verandah Area	75.60m <sup>2</sup>
Total Area	151.20m <sup>2</sup>

Let the Westwood become your sanctuary. Beautifully balanced, with shady verandahs on three sides, the Westwood truly lives up to its name.

### Floor Plan

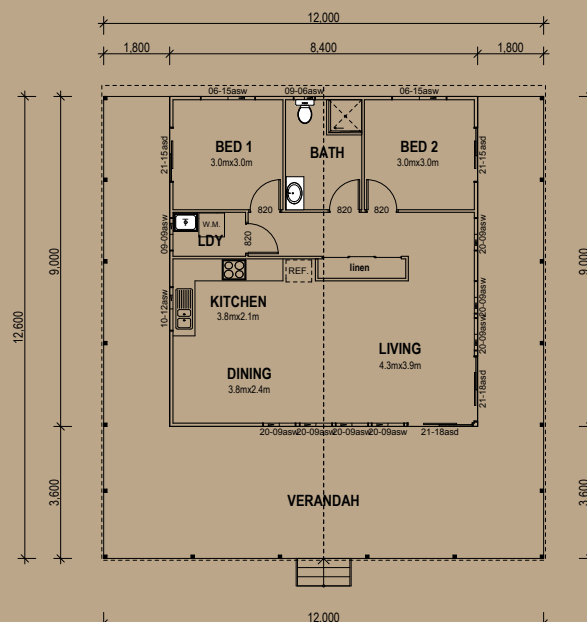

5A Hartnett Close, Mulgrave, VIC  
 PO Box 2516, Mt Waverley, VIC 3149  
 1800 679 268

Web: [i-build.com.au](http://i-build.com.au) email: [info@i-build.com.au](mailto:info@i-build.com.au)