





**iBUILD™**  
Building Solutions

STRONGER • SMARTER • FASTER  
**MORE AFFORDABLE**

**KIT HOMES**

**AVILA**

With a straightforward design and stylish encompassing verandah, the Kit Homes Avila is a winner for anyone looking for a dynamic space.

ENCLOSED	OTHER
60.00m <sup>2</sup>	18.00m <sup>2</sup>
<b>TOTAL 78.00m<sup>2</sup></b>	
 2  1  1	



1800 679 268  
info@i-build.com.au  
www.i-build.com.au

[Facebook@ibuildau](#)  
[YouTube@ibuildbuilding](#)  
[Pinterest@ibuildbuildings](#)

Eastern Innovation  
5A Hartnett Close  
Mulgrave VIC 3170

© copyright iBuild - v9.17 20220930

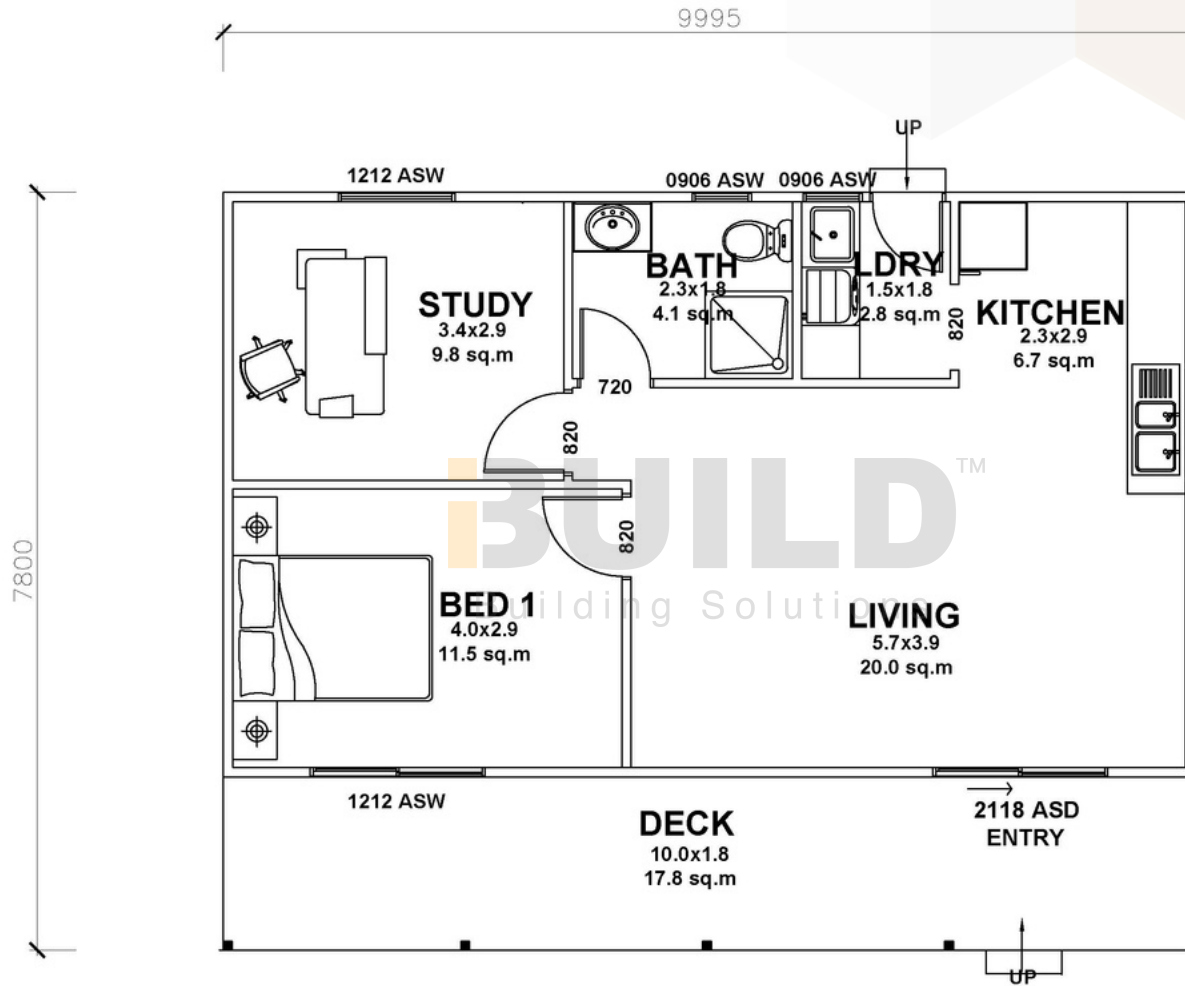

1012 ASW

7800

9995

1212 ASW

0906 ASW 0906 ASW

UP

**STUDY**  
3.4x2.9  
9.8 sq.m

**BATH**  
2.3x1.8  
4.1 sq.m

**DRY**  
1.5x1.8  
2.8 sq.m

**KITCHEN**  
2.3x2.9  
6.7 sq.m

720

820

820

**BED 1**  
4.0x2.9  
11.5 sq.m

**LIVING**  
5.7x3.9  
20.0 sq.m

1212 ASW

**DECK**  
10.0x1.8  
17.8 sq.m

2118 ASD  
ENTRY

UP

