

# TRANSPACK P200

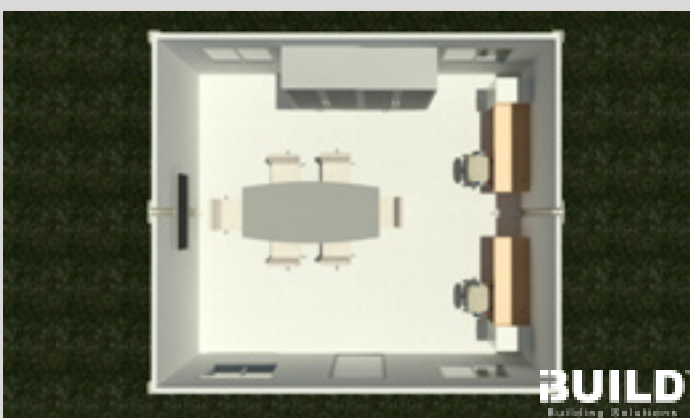

TOP-DOWN PERSPECTIVE

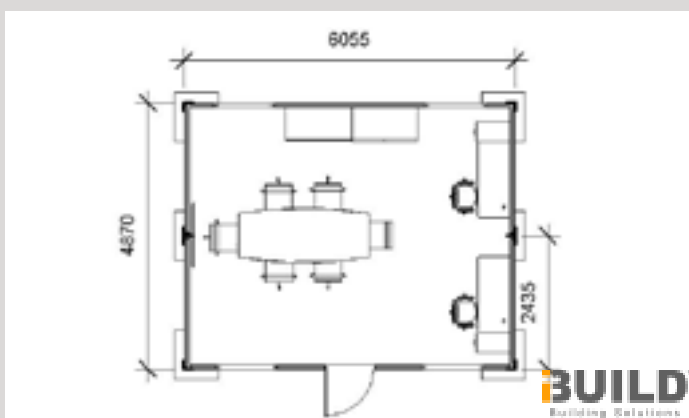

FLOOR PLAN

- Two standard 20ft modules combined
- Durable prefabricated steel frame
- Insulated ceiling, walls, and floors
- Engineered by Australians for Australia and beyond
- Fast onsite assembly
- Combine modules for a larger footprint

LIVING

30m<sup>2</sup>

TOTAL 30m<sup>2</sup>

**BUILDING ONLY**