

TRANSPACK P300

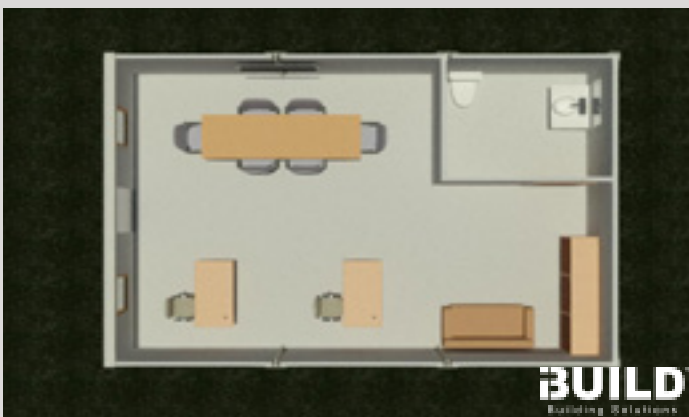

TOP-DOWN PERSPECTIVE

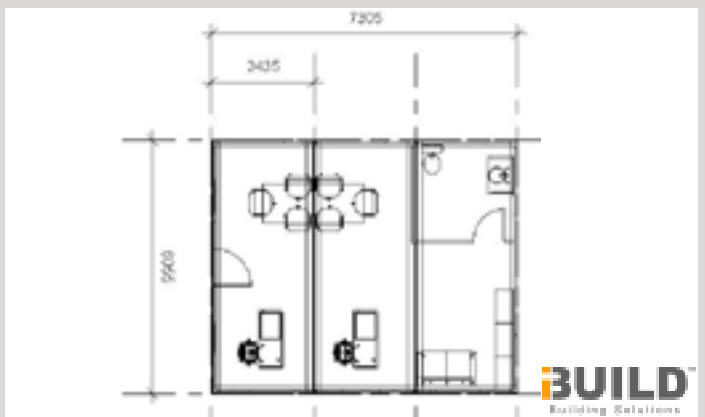

FLOOR PLAN

- Three 20ft modules combined
- Durable prefabricated steel frame
- Insulated ceiling, walls, and floors
- Engineered by Australians for Australia and beyond
- Fast onsite assembly
- Combine modules for a larger footprint
- Plan includes bathroom

LIVING	BATHROOM
40m ²	5m ²

TOTAL 45m²

