

# 6 CONSTRUCTION STAGES

The construction stages for a timber frame project, and required trades for each.

**TRADES**

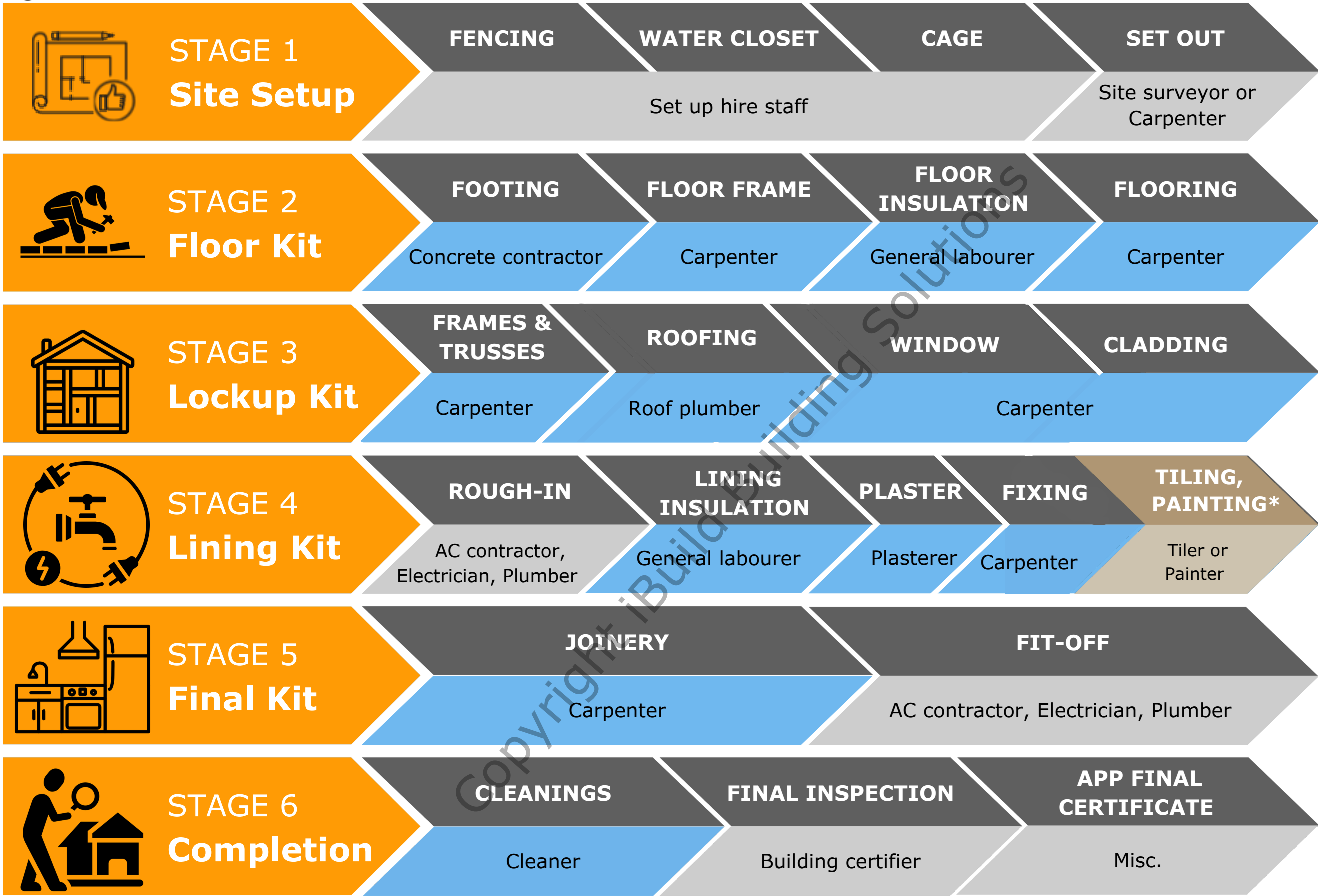

LEGEND: Required trade (blue) \* Not included in iBuild kits (grey)

Can be completed by an Owner Builder, conditions apply in certain states

This is a guide only. Not all builds are the same. Some tasks can be completed concurrently. If you have any questions please speak to your builder or project manager for more tailored support. iBuild does not supply site equipment.

# 6 CONSTRUCTION STAGES

## THE PROCESS

### STAGE 1: SITE SETUP THIS INITIAL STAGE FOCUSES ON PREPARING THE CONSTRUCTION SITE

#### FENCING

Ensuring safety and restricting unauthorized access with temporary fencing.

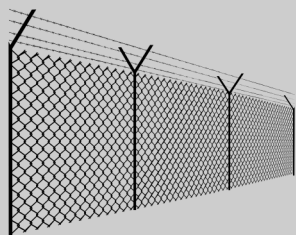

#### WATER CLOSET

Establishing temporary toilet facilities for workers on the construction site.

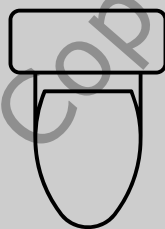

#### CAGE

Providing an extra layer of security, especially for important equipment and materials by installing a cage.

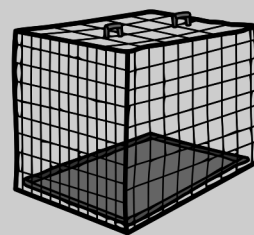

#### SET OUT

Bringing the dimensions from a plan to the site, ensuring accurate placement of the building and utilities.

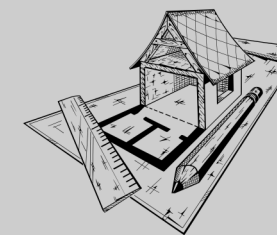

This is a guide only. Not all builds are the same. Some tasks can be completed concurrently. If you have any questions please speak to your builder or project manager for more tailored support. iBuild does not supply site equipment.

# 6 CONSTRUCTION STAGES

## THE PROCESS

### STAGE 2: FLOOR KIT HERE, THE FOUNDATION OF THE HOME IS LAID OUT.

#### FOOTING

Supporting the foundation, prevent settling and ensuring the entire structure doesn't sink into the ground

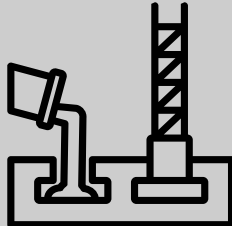
A technical diagram showing a cross-section of a footing. It depicts a vertical post (likely a wall or column) resting on a wider, rectangular base (the footing) which is embedded into the ground. A small excavator bucket is shown to the left, suggesting the ground preparation process.

#### FLOOR FRAME

Constructing the timber or steel frames that will form the floors and support the walls.

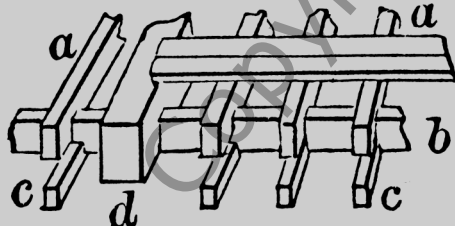
A technical diagram of a floor frame. It shows a series of parallel joists supported by vertical posts. The joists are labeled with 'a' and 'b', and the posts with 'c' and 'd', illustrating the structural layout.

#### FLOOR INSULATION

Installing insulation in the floor to improve energy efficiency and thermal comfort.

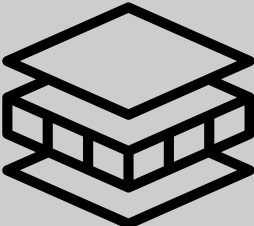
A diagram showing three layers of insulation. The top layer is a thick, rectangular block. Below it are two thinner, rectangular blocks, representing different types of insulation materials used in a floor assembly.

#### FLOORING

This step involves laying the finished floor surface, such as hardwood, tile, or laminate.

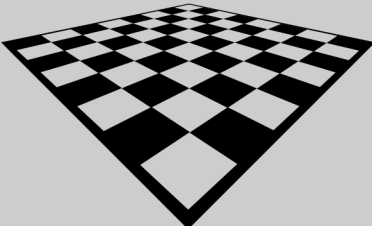
A diagram of a checkered floor surface, representing a finished floor like tile or laminate. The checkered pattern is shown in perspective, receding into the distance.

This is a guide only. Not all builds are the same. Some tasks can be completed concurrently. If you have any questions please speak to your builder or project manager for more tailored support. iBuild does not supply site equipment. Your floor type is dependent on the site and other requirements, some of these steps may be unnecessary.

# 6 CONSTRUCTION STAGES

## THE PROCESS

### STAGE 3: LOCK UP KIT

THE MAIN STRUCTURE OF THE HOUSE  
WILL BE CONSTRUCTED AT THIS STAGE



This is a guide only. Not all builds are the same. Some tasks can be completed concurrently. If you have any questions please speak to your builder or project manager for more tailored support. iBuild does not supply site equipment.

# 6 CONSTRUCTION STAGES

## STAGE 4: LINING KIT

THE FOCUS SHIFTS TO THE INTERIOR OF THE HOME IN THIS STAGE.

### ROUGH-IN

Install of plumbing, electrical wiring, and other services before the walls are enclosed.

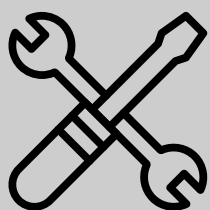

### LINING INSULATION

Insulating the walls and other areas improves energy efficiency and soundproofing within the home.

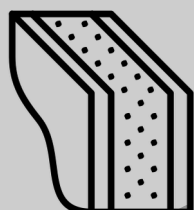

### PLASTER

Plastering the interior walls and ceilings to create a smooth, finished surface ready for painting or wallpapering.

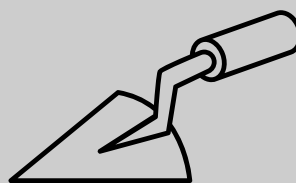

### FIXING

Finalizing the interior works involves installing fixtures, fittings, and other finishing touches to complete the interior design.

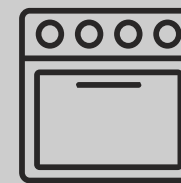

### TILING/PAINING

*iBuild does not provide tiles or paint, but now is the time to do it if you'd like it!*

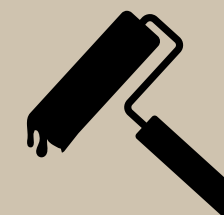

# 6 CONSTRUCTION STAGES

**STAGE 5: FINAL KIT**  
AS THE CONSTRUCTION NEARS  
COMPLETION, THIS STAGE INVOLVES  
FINISHING TOUCHES INSIDE THE HOME.

## JOINERY

Installing final joinery,  
such as items for kitchen,  
laundry and bathroom.

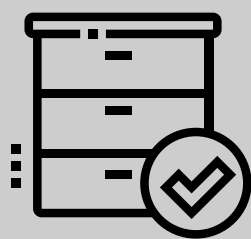

## FIT-OFF

Adding any remaining  
fixtures, fittings, or  
decorative elements and  
ensuring those items  
function correctly.



This is a guide only. Not all builds are the same. Some tasks can be completed concurrently. If you have any questions please speak to your builder or project manager for more tailored support. iBuild does not supply site equipment.



# 6 CONSTRUCTION STAGES

## THE PROCESS

### STAGE 6: COMPLETION

THE FINAL STAGE OF FINISHING TOUCHES AND INSPECTIONS NECESSARY TO FINALIZE THE CONSTRUCTION PROCESS.

#### CLEANINGS

Thoroughly cleaning the site and the completed building ensures a safe and presentable environment for occupants.

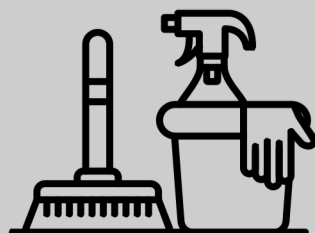

#### FINAL INSPECTION

Undergoing a final inspection by relevant authorities ensures that the building meets all regulatory standards and is safe for occupancy.



#### APP FINAL CERTIFICATE

Final certificate/checks:

- General plumbing
- Roof plumbing
- Electricals
- Insulation
- Glazing
- Water proofing
- Termites certificates A&B

This is a guide only. Not all builds are the same. Some tasks can be completed concurrently. If you have any questions please speak to your builder or project manager for more tailored support. iBuild does not supply site equipment.