

**KIT HOMES**

# Oxford 44

The Kit Homes Oxford 44 is independent living at its finest. This update to an iBuild 1 bedroom classic comes with everything you need in from a spacious living/kitchen area to bathroom bathroom/laundry to die for.

ENCLOSED	OTHER	
<b>40.29m<sup>2</sup></b>	<b>12.89m<sup>2</sup></b>	
<b>TOTAL 53.18 m<sup>2</sup></b>		
1	1	1

For a larger view of our floor plans, please check our website.



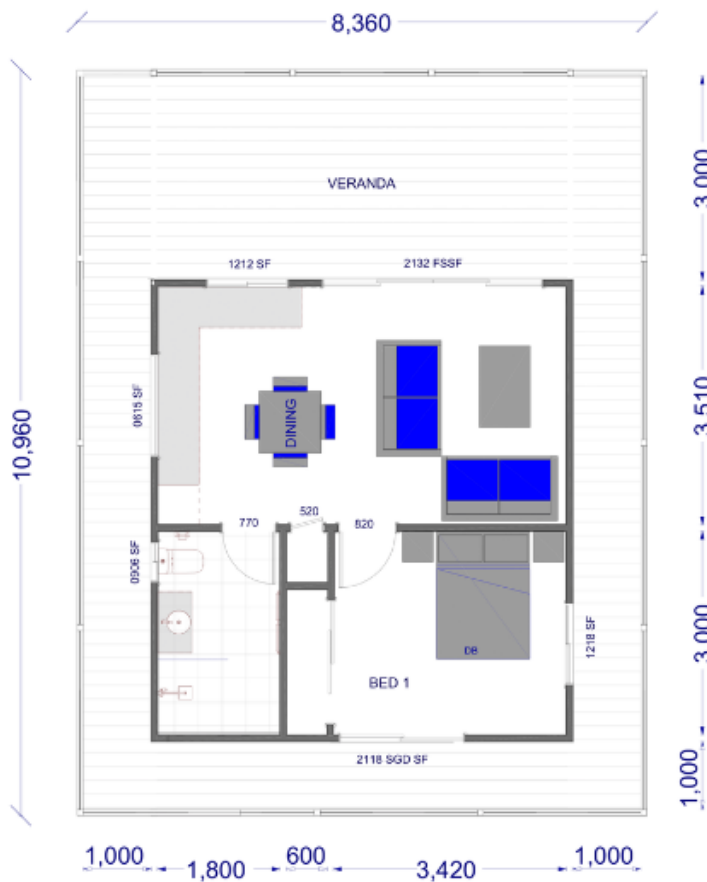

**KIT HOMES**

# Newman

The Kit Homes Newman has an all-encompassing verandah that gives you a vantage point to look out from in every direction. With a deluxe bedroom combined with a spacious living area, the Kit Homes Newman will leave you wanting for nothing.

ENCLOSED	OTHER
42.17m <sup>2</sup>	49.44m <sup>2</sup>
<b>TOTAL 91.61m<sup>2</sup></b>	
1	1  1

For a larger view of our floor plans, please check our website.





**KIT HOMES**

# Kingaroy

The Kit Homes Kingaroy is the dream home that you have been wanting. With a large verandah and an open living room, the Kingaroy gives you the space to both entertain and relax. This 1 bedroom home provides luxury living for an affordable price.

ENCLOSED	OTHER	
<b>64.94m<sup>2</sup></b>	<b>26.49m<sup>2</sup></b>	
<b>TOTAL 91.43m<sup>2</sup></b>		
1	1	1

For a larger view of our floor plans, please check our website.





**KIT HOMES**

**OXFORD**

The compact Oxford is the ideal home for independent living. This 1 bedroom kit home comes with a cosy living area and an outdoor verandah so you can enjoy the best of both an indoor and outdoor lifestyle.

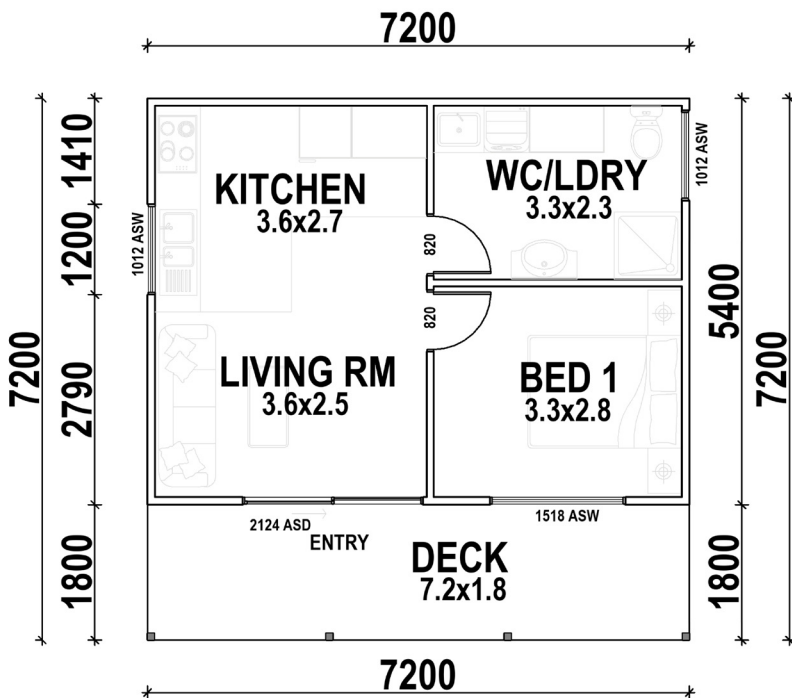

ENCLOSED	OTHER	
38.88m <sup>2</sup>	12.96m <sup>2</sup>	
<b>TOTAL 51.84m<sup>2</sup></b>		
1	1	1

For a larger view of our floor plans, please check our website.



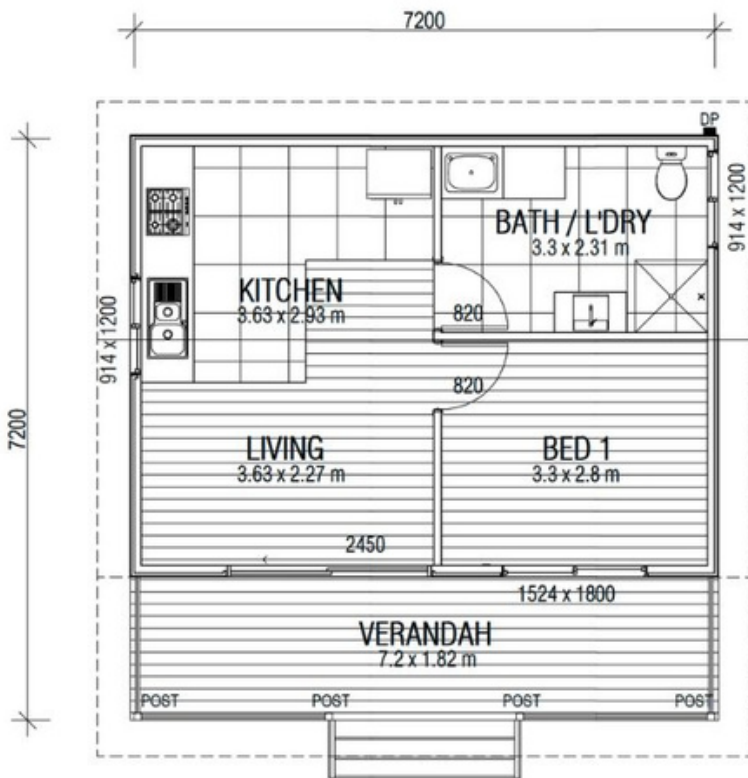

**KIT HOMES**

# Oxford 44

The Kit Homes Oxford 44 is independent living at its finest. With a spacious living and dining area, this one-bedroom kit home has everything you are looking for

ENCLOSED	OTHER	
<b>40.29m<sup>2</sup></b>	<b>12.89m<sup>2</sup></b>	
<b>TOTAL 53.18 m<sup>2</sup></b>		
1	1	1

For a larger view of our floor plans, please check our website.



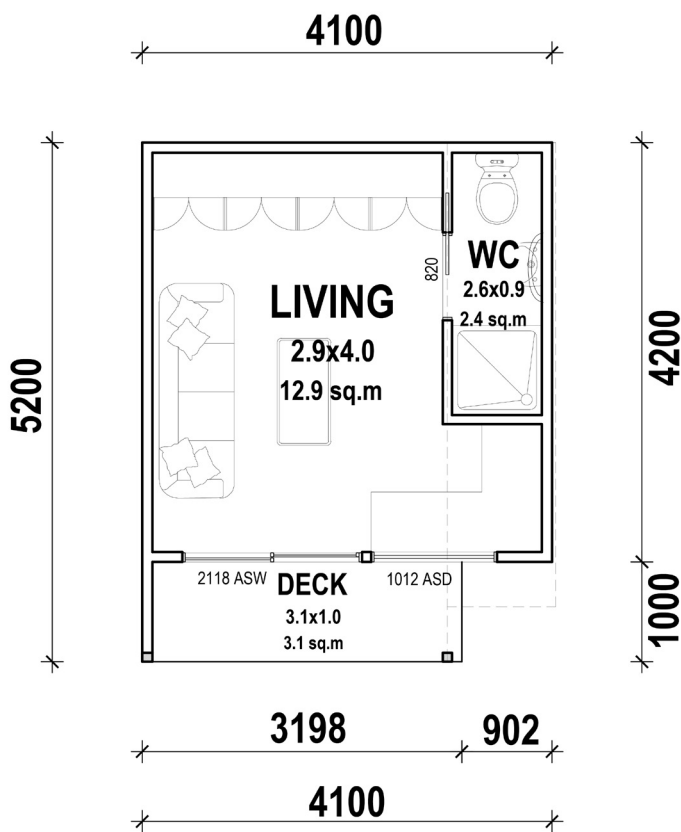

**KIT HOMES**

**OAKDALE**

With a spacious living room and an outdoor deck, the small and compact Oakdale is the perfect addition to your property.

ENCLOSED	OTHER
17.22m <sup>2</sup>	3.20m <sup>2</sup>
<b>TOTAL 20.42m<sup>2</sup></b>	

For a larger view of our floor plans, please check our website.





**KIT HOMES**

# Oakdale 44

The dynamic kitchen nook and open living space provides you with everything you need all in one deluxe compact cabin, whether on a residential lot or in a caravan park.

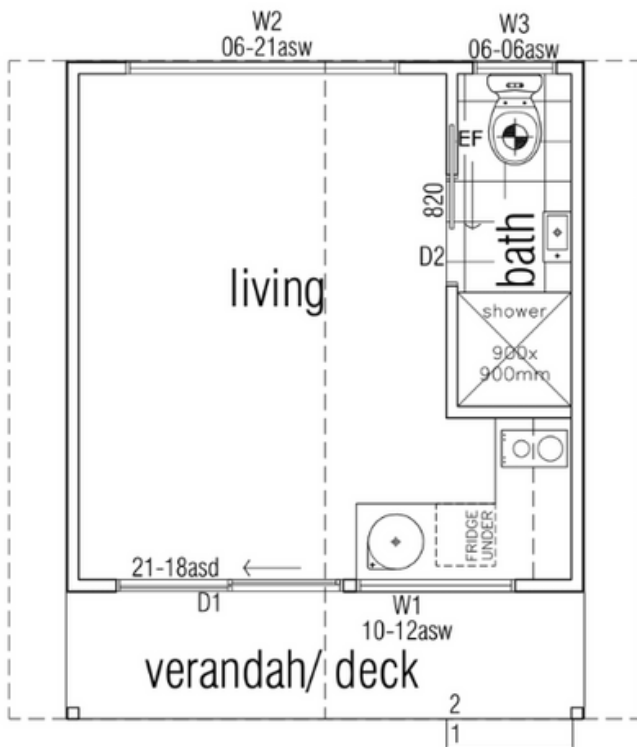

ENCLOSED	OTHER	
17.46m <sup>2</sup>	4.27m <sup>2</sup>	
<b>TOTAL 21.73m<sup>2</sup></b>		
1	1	1

For a larger view of our floor plans, please check our website.





**iBUILD**<sup>TM</sup>  
Building Solutions

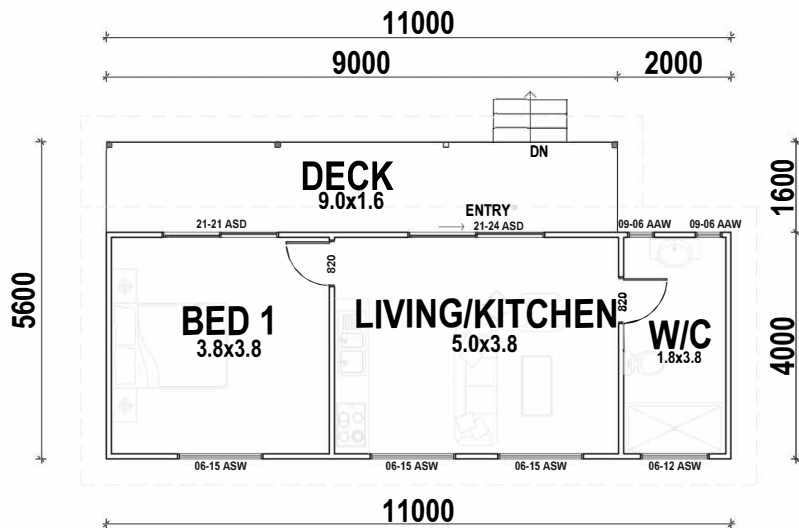

**KIT HOMES**

**WHYALLA**

With its slanted roof and open style verandah, the Kit Homes Whyalla is perfect for personal sanctuaries and entertainment areas to suit most lifestyles.

ENCLOSED	OTHER
44.00m <sup>2</sup>	14.40m <sup>2</sup>
<b>TOTAL 58.40m<sup>2</sup></b>	
1	1
1	

For a larger view of our floor plans, please check our website.





**iBUILD**<sup>TM</sup>  
Building Solutions

**KIT HOMES**

**BALLINA**

The Kit Homes Ballina offers an area of relaxation that can be escaped to. Perfect for a backyard granny flat or standalone unit, the Kit Homes Ballina opens many doors to possibilities.

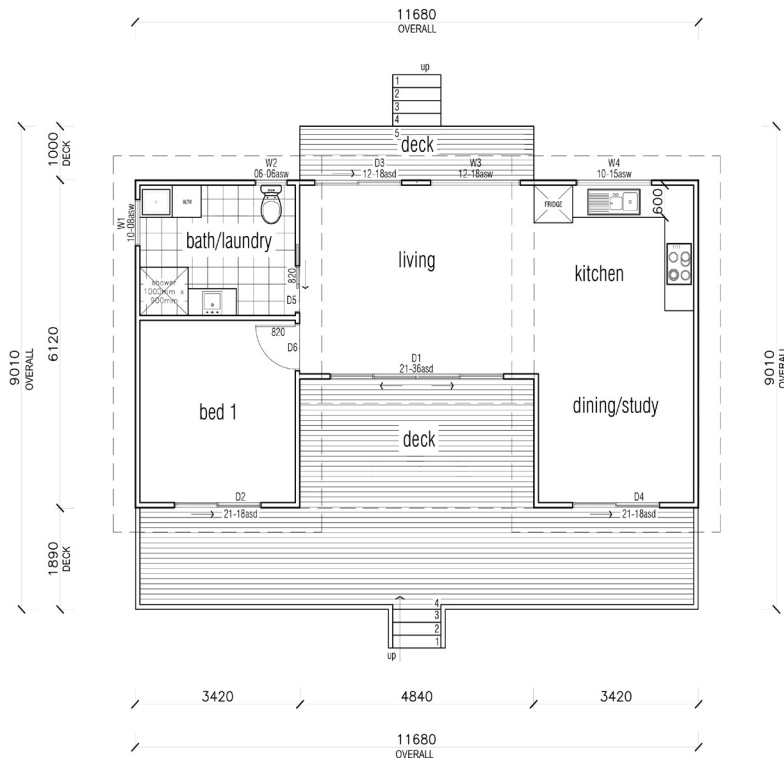

ENCLOSED	OTHER
59.86m <sup>2</sup>	38.50m <sup>2</sup>

**TOTAL 98.36m<sup>2</sup>**



For a larger view of our floor plans, please check our website.





**KIT HOMES**

**BERWICK**

The compact Kit Homes Berwick is ideal for a granny flat or independent living. The plan takes into account all the essentials in addition to a cosy living area and verandah.

ENCLOSED	OTHER
<b>33.28m<sup>2</sup></b>	<b>8.32m<sup>2</sup></b>
<b>TOTAL 41.60m<sup>2</sup></b>	
1	1
	1

For a larger view of our floor plans, please check our website.







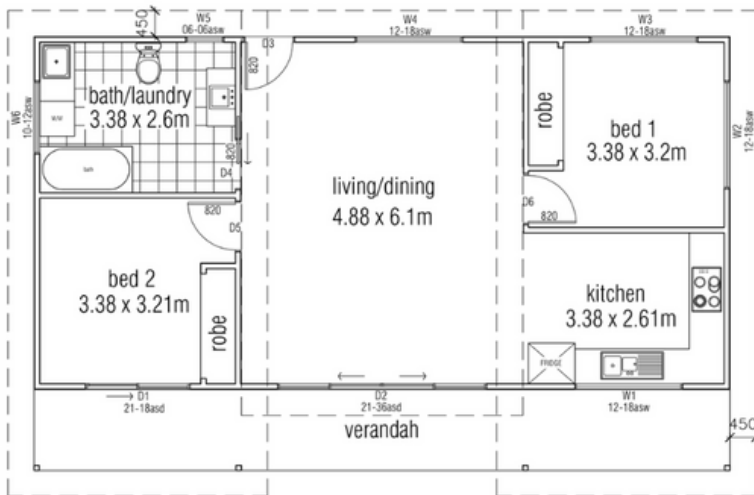

**KIT HOMES**

# Melrose 44

The Kit Homes Melrose 44 is open living at its finest. This two-bedroom Kit home has everything you're looking for, with a spacious living and dining area. Whether you're looking to build a home for your retirement or a place to vacation, the Kit Homes Melrose 44 is perfect.



ENCLOSED	OTHER
<b>73.74m<sup>2</sup></b>	<b>16.78m<sup>2</sup></b>
<b>TOTAL 90.52m<sup>2</sup></b>	
 2  1  1	

For a larger view of our floor plans, please check our website.



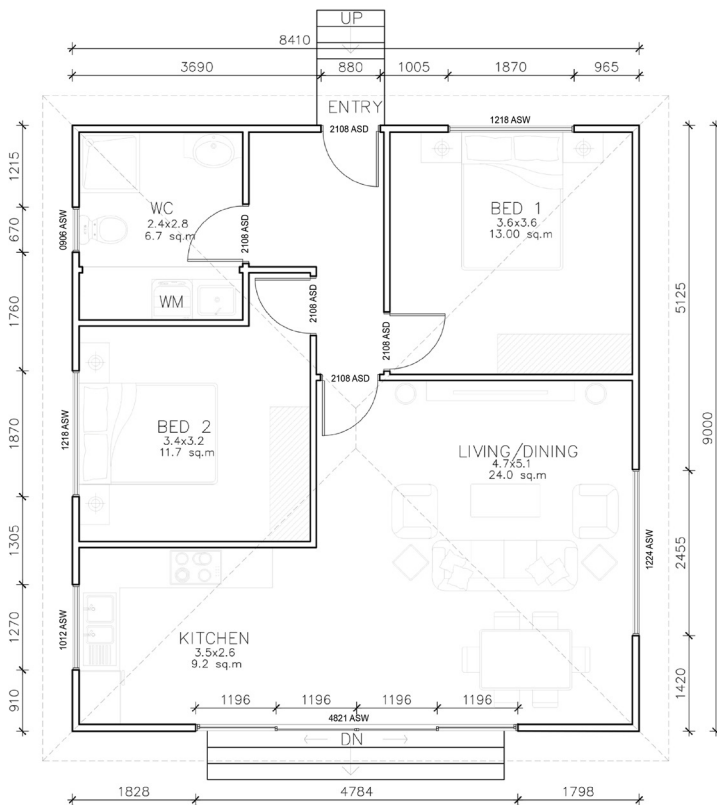

**KIT HOMES**

**CASA BIANCA**

The compact Casa Bianca is perfect for small families looking for a holiday home. The eye catching kit home comes packed with 2 bedrooms and cozy living areas, making it the perfect place to enjoy your holiday.

ENCLOSED	OTHER
<b>75.07m<sup>2</sup></b>	<b>0.00m<sup>2</sup></b>
<b>TOTAL 75.07m<sup>2</sup></b>	
2	1  1

For a larger view of our floor plans, please check our website.





**KIT HOMES**

**CASA BIANCA 42**

The sister to the original Kit Homes Casa Bianca, the Casa Bianca 42 similarly brings a perfectly holiday feeling to a compact kit home. Boasting 2 bedrooms, and an open living area with panoramic views, the Kit Homes Casa Bianca 42 brings the calm to your doorstep.

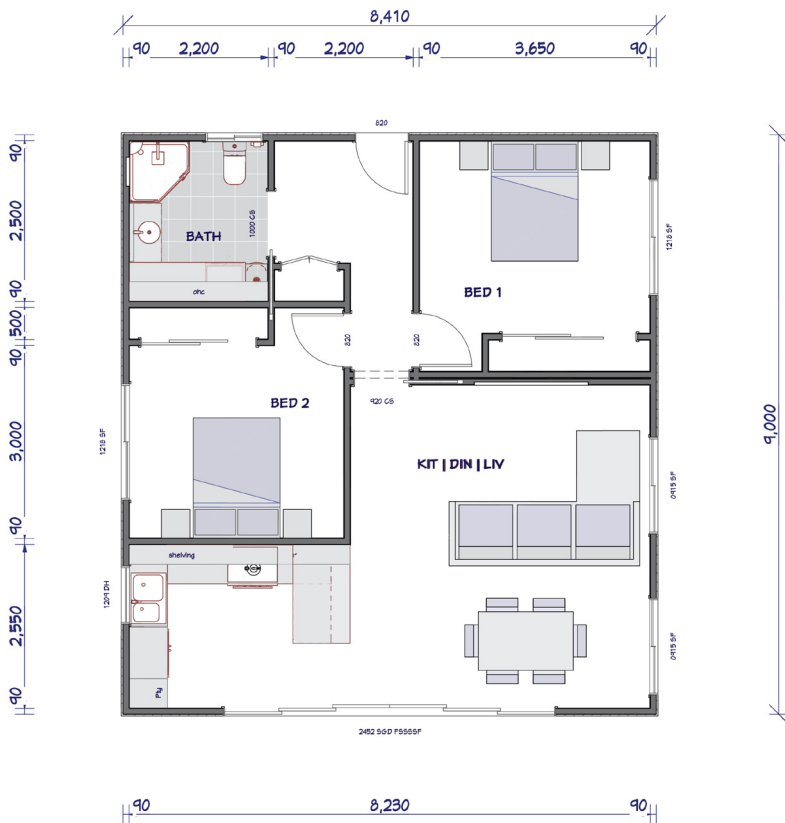

ENCLOSED	OTHER
75.69m <sup>2</sup>	0.00m <sup>2</sup>
<b>TOTAL 75.69m<sup>2</sup></b>	
2	1
	1

For a larger view of our floor plans, please check our website.



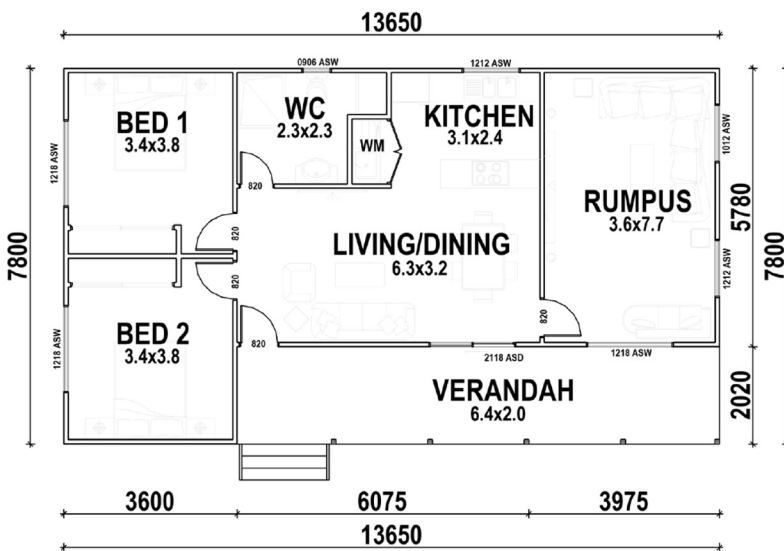



**KIT HOMES**

**ROMA**

The contemporary design with an open floor plan highlights a neat verandah shading the living area. The Roma would perfectly suit those looking for a Granny flat or something similar.

ENCLOSED	OTHER
86.17m <sup>2</sup>	20.30m <sup>2</sup>
<b>TOTAL 106.47m<sup>2</sup></b>	
 2  1  1	

For a larger view of our floor plans, please check our website.





**KIT HOMES**

**WESTWOOD**

Let the Westwood become your sanctuary. Beautifully balanced, and with shady verandahs on three sides, the Westwood truly lives up to its name.

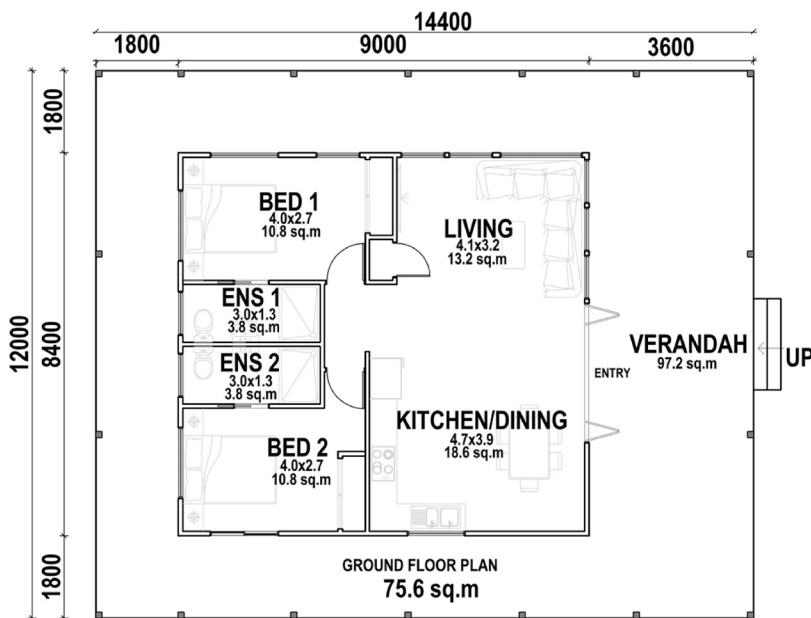

ENCLOSED	OTHER
75.60m <sup>2</sup>	97.20m <sup>2</sup>
<b>TOTAL 172.80m<sup>2</sup></b>	
2	2
	1

For a larger view of our floor plans, please check our website.







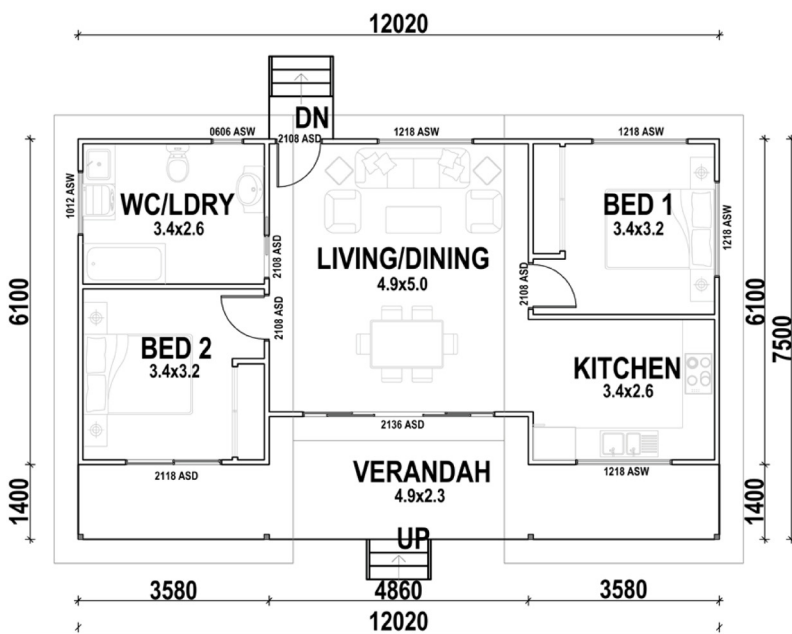

**KIT HOMES**

**MELROSE**

This modern looking design with its skillion roof is neat and compact. Kit homes Melrose is perfectly suited for a retired couple. It can be used for a vacation/holiday home due to its features. The snug deck leading off the living area is ideal for alfresco dining.



ENCLOSED	OTHER
68.37m <sup>2</sup>	22.16m <sup>2</sup>
<b>TOTAL 91.11m<sup>2</sup></b>	
 2  1  1	

For a larger view of our floor plans, please check our website.





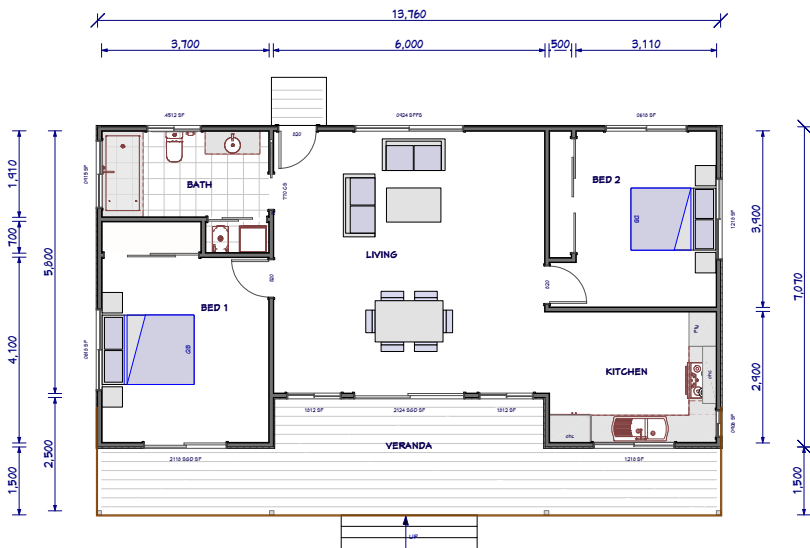

**iBUILD**<sup>TM</sup>  
Building Solutions



**KIT HOMES**

**MELROSE 42**

The modern Kit Homes Melrose 42 brings the same charisma and contemporary feelings of the original Melrose, with a slightly larger footprint. The living area opens up to the spacious deck and alfresco area for all your entertaining needs.

ENCLOSED	OTHER
91.92m <sup>2</sup>	27.78m <sup>2</sup>
<b>TOTAL 119.70m<sup>2</sup></b>	
 2  1  1	

For a larger view of our floor plans, please check our website.







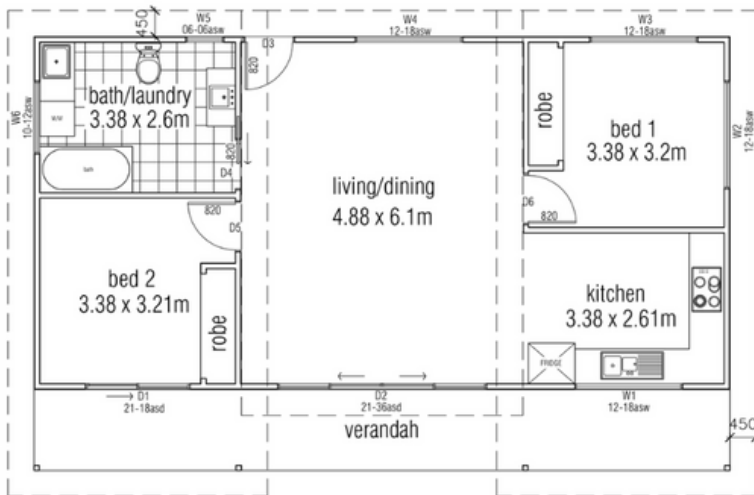

**KIT HOMES**

# Melrose 44

The Kit Homes Melrose 44 is open living at its finest. This two-bedroom Kit home has everything you're looking for, with a spacious living and dining area. Whether you're looking to build a home for your retirement or a place to vacation, the Kit Homes Melrose 44 is perfect.



ENCLOSED	OTHER	
<b>73.74m<sup>2</sup></b>	<b>16.78m<sup>2</sup></b>	
<b>TOTAL 90.52m<sup>2</sup></b>		
 2	 1	 1

For a larger view of our floor plans, please check our website.





**KIT HOMES**

# Orange

The Kit Home Orange is a beautifully designed home, with a simplistic but sophisticated open living and dining area that is perfect for any family's lifestyle.

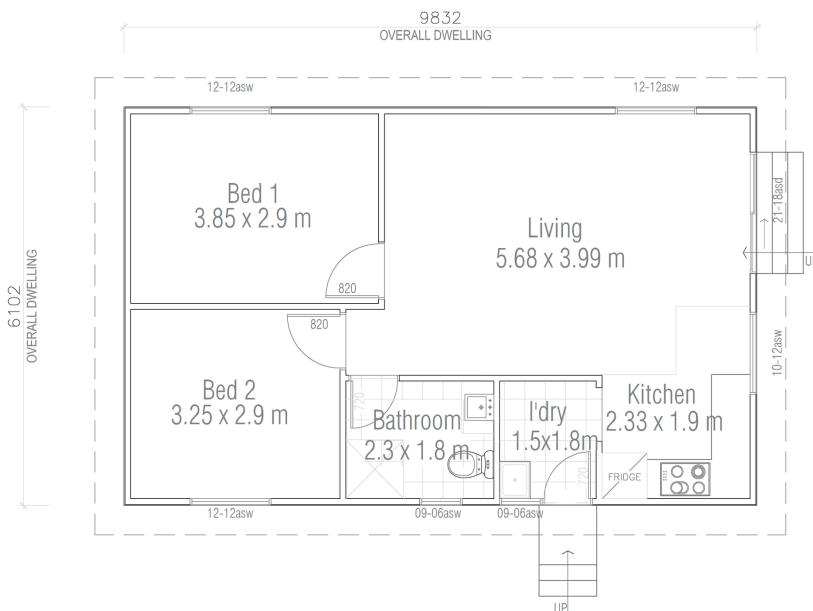

ENCLOSED	OTHER
<b>59.7 m<sup>2</sup></b>	<b>0 m<sup>2</sup></b>
<b>TOTAL 53.18 m<sup>2</sup></b>	
2	1
	1

For a larger view of our floor plans, please check our website.





**KIT HOMES**

**PORTLAND**

If you're looking for neat and compact cabins, the Portland is for you. Ideal as a fishing lodge, art studio, holiday cabin or a parent retreat, the Portland will catch the breezes and show you amazing views.

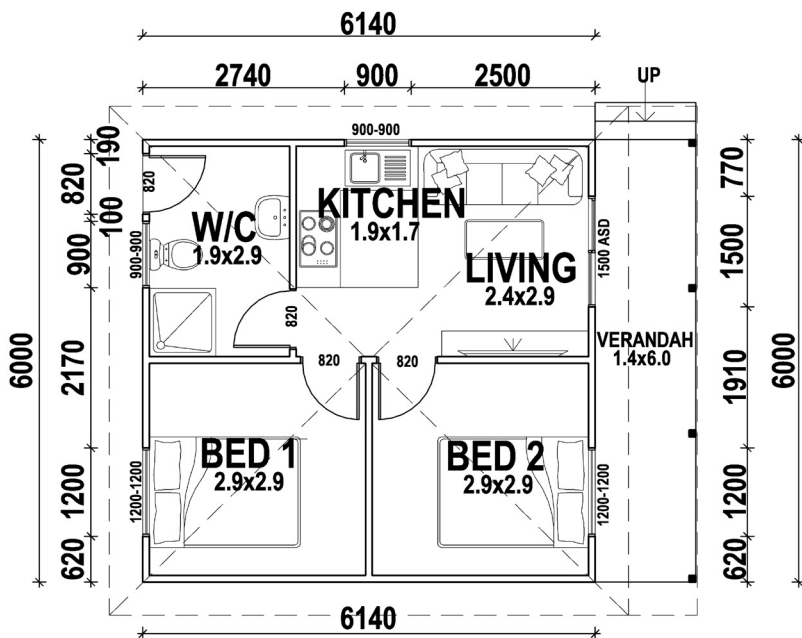

ENCLOSED	OTHER
36.84m <sup>2</sup>	8.40m <sup>2</sup>

**TOTAL 45.24m<sup>2</sup>**

 2
  1
  1

For a larger view of our floor plans, please check our website.



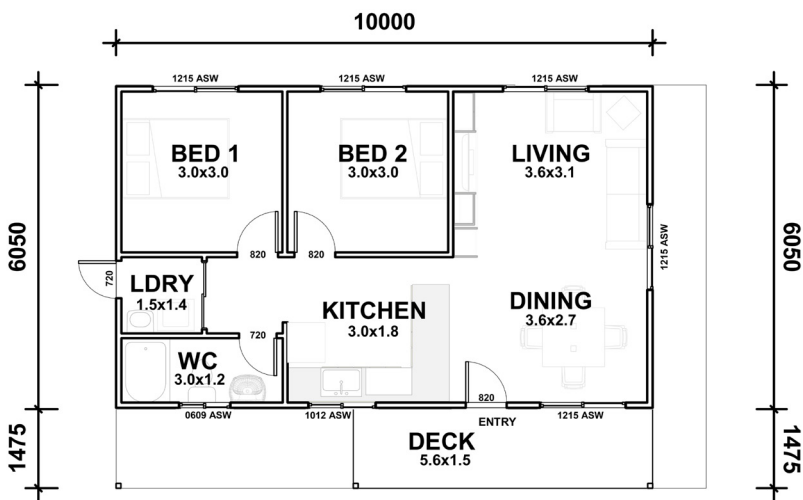

**KIT HOMES**

**PARRAMATTA**

The 2 bedroom Parramatta comes packed with everything you need in a granny flat. The simple design is complimented by a front deck which will allow you to enjoy the outdoors making it an ideal choice for a granny flat.

ENCLOSED	OTHER
<b>60.00m<sup>2</sup></b>	<b>8.37m<sup>2</sup></b>
<b>TOTAL 68.37m<sup>2</sup></b>	
2	1
	1

For a larger view of our floor plans, please check our website.



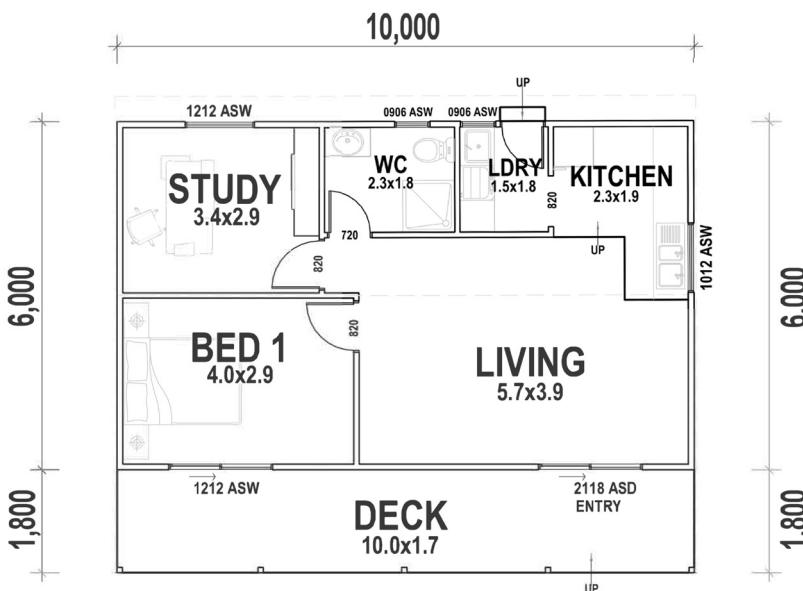



**KIT HOMES**

**AVILA**

With the simplistic design and full verandah across the front, the Avila is always a winner for folks looking at homes of this size.

ENCLOSED	OTHER
60.00m <sup>2</sup>	18.00m <sup>2</sup>
<b>TOTAL 78.00m<sup>2</sup></b>	
 2	 1
 1	

For a larger view of our floor plans, please check our website.





**KIT HOMES**

**MACKAY**

Compact, stylish, and modern, this symmetrical fantasy flawlessly amalgamates space and luxury to bring you outstanding country-living. Let Mackay's verandah keep you cool as you immerse yourself in what the surrounding landscape has to offer.

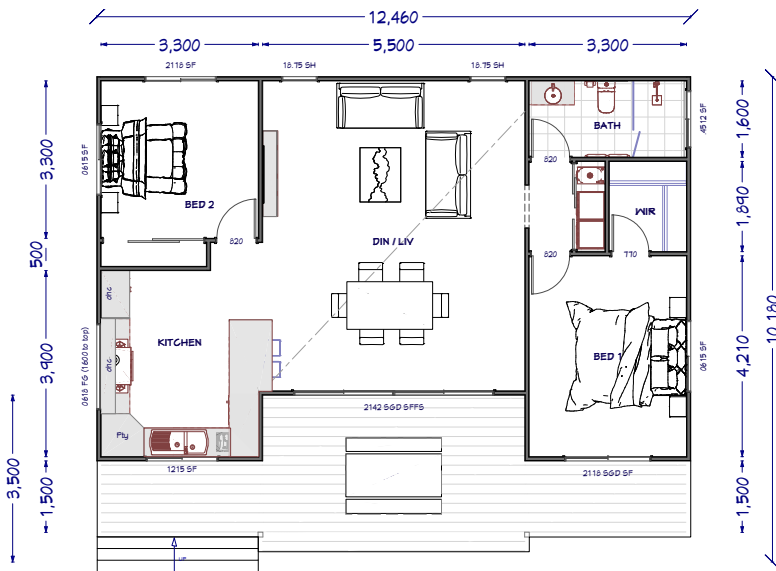

ENCLOSED	OTHER
93.00m <sup>2</sup>	31.00m <sup>2</sup>

**TOTAL 124.00m<sup>2</sup>**

 2
  1
  1

For a larger view of our floor plans, please check our website.





**iBUILD**<sup>TM</sup>  
Building Solutions

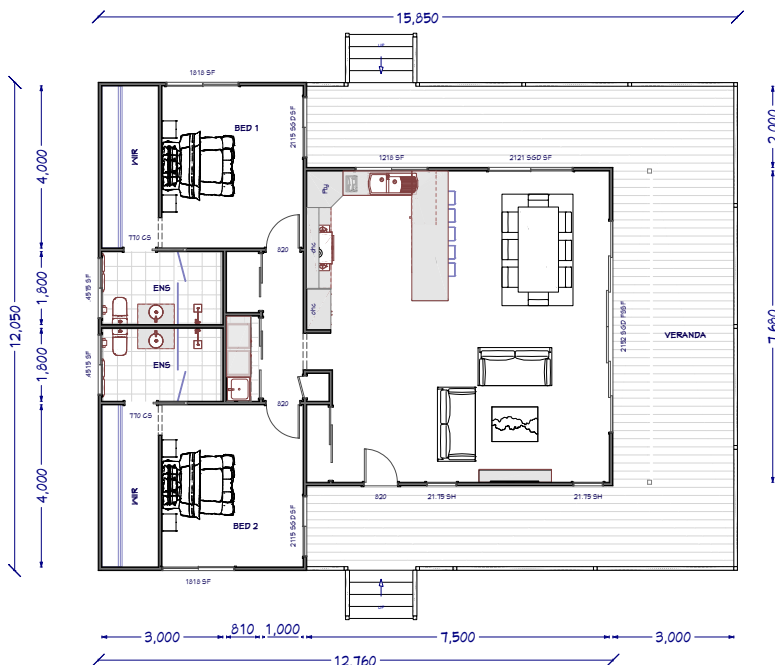

**KIT HOMES**

**TAMWORTH**

Bring your dreams to life with the Tamworth in all its glory. The wrap around verandah is sure to be the forefront of many family memories being made. Ideal for small families, the spacious design offers ample room and privacy to all.

ENCLOSED	OTHER
123.00m <sup>2</sup>	68.00m <sup>2</sup>
<b>TOTAL 191.00m<sup>2</sup></b>	
2	2
	1

For a larger view of our floor plans, please check our website.



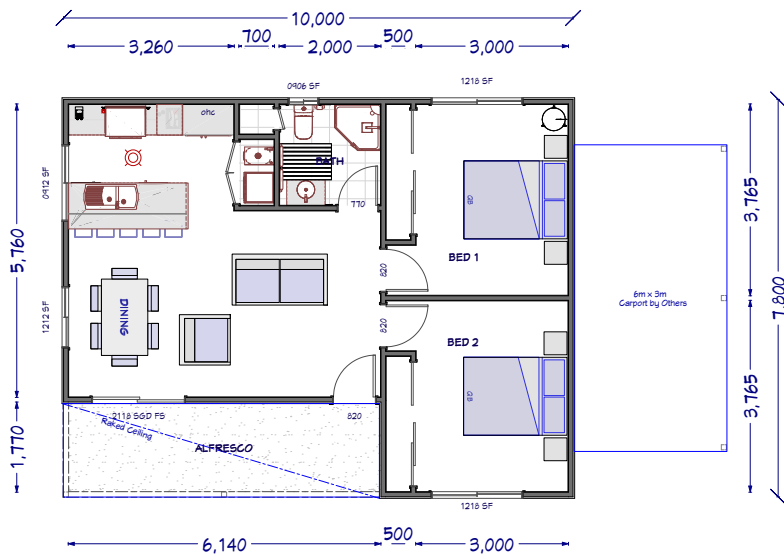

**KIT HOMES**

**EMERALD**

A blend between traditional and modern style, the Kit Homes Emerald compliments grand aesthetics for those with a contemporary eye.

ENCLOSED	OTHER
66.50m <sup>2</sup>	11.50m <sup>2</sup>
<b>TOTAL 78.00m<sup>2</sup></b>	
2	1
	1

For a larger view of our floor plans, please check our website.



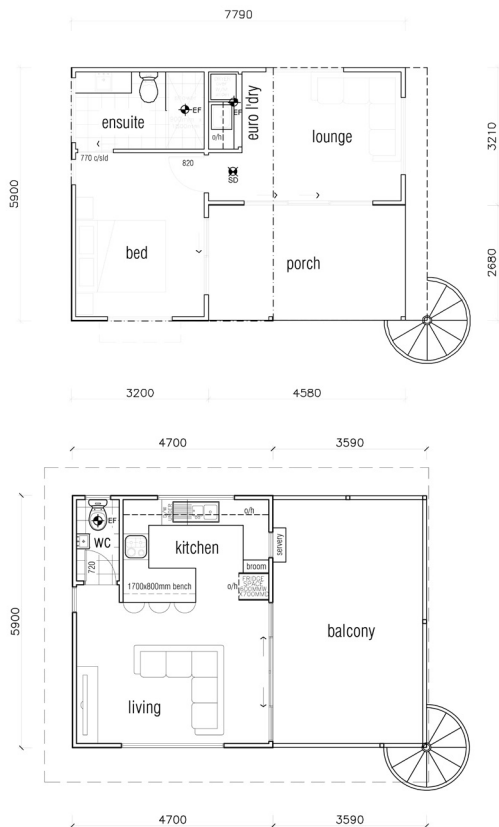
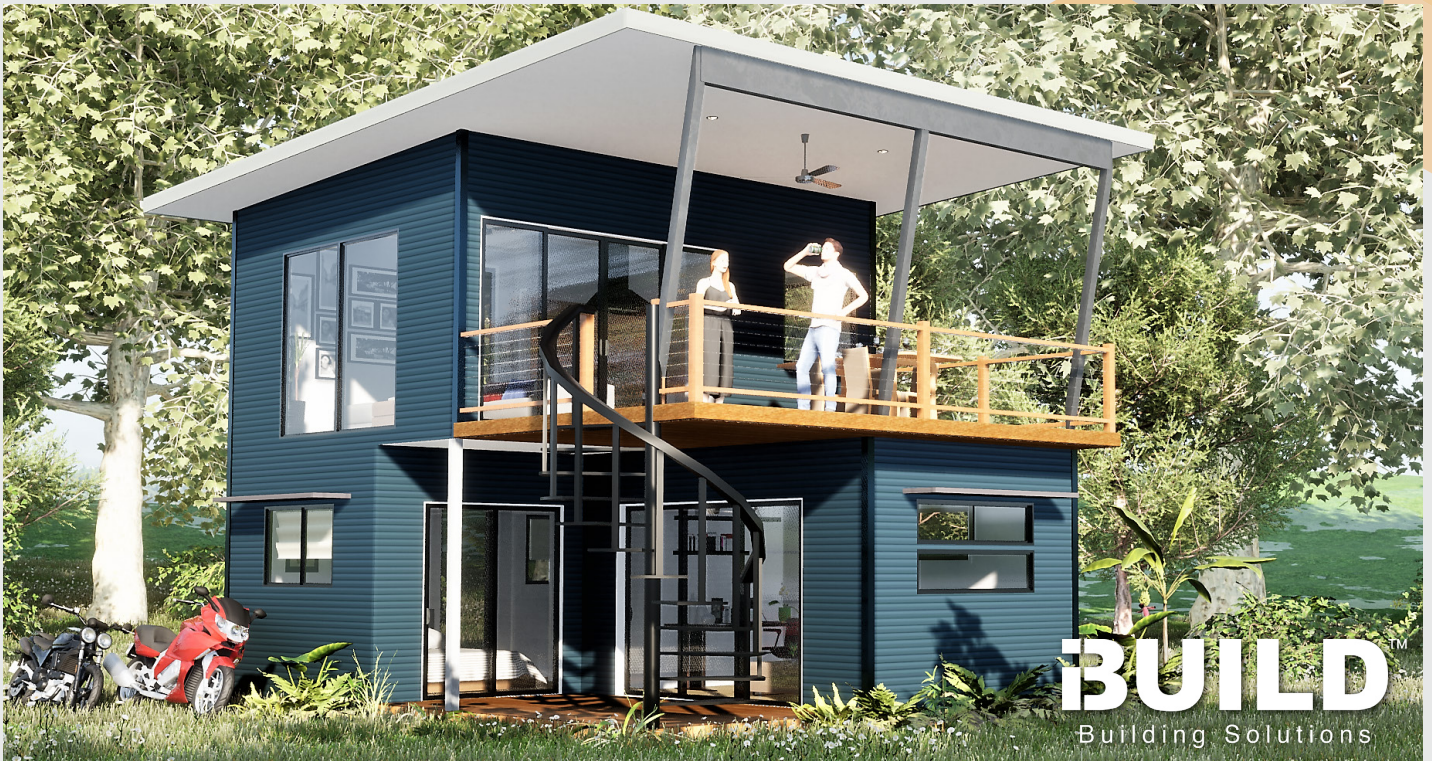

**KIT HOMES**

**ABBHEY VIEW**

The Kit Homes Abbey View allows for some great scenic views as a double storey holiday house with an impressive entertainment deck for those warm evenings.

ENCLOSED	OTHER
61.34m <sup>2</sup>	33.37m <sup>2</sup>
<b>TOTAL 94.71m<sup>2</sup></b>	
2	2
	1

For a larger view of our floor plans, please check our website.



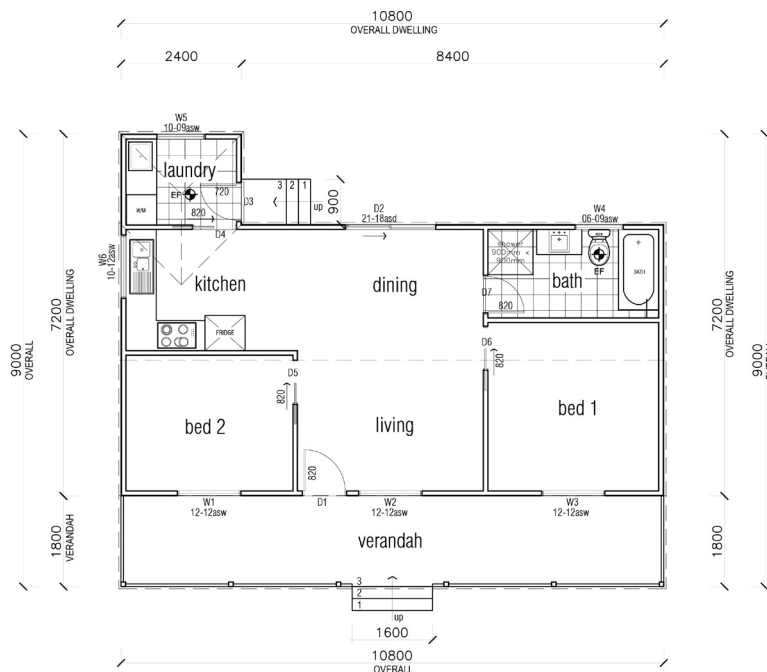



**KIT HOMES**

**ARMIDALE**

Ideal for young families or retired people, Kit Homes Armidale will take no time to make you feel comfortable. Living room and both bedrooms have the verandah facing windows for enough natural light to brighten your home. An exclusive laundry room for people wanting it to be separate from the main living areas.

ENCLOSED	OTHER
62.64m <sup>2</sup>	19.44m <sup>2</sup>
<b>TOTAL 82.08m<sup>2</sup></b>	
 2	 1
	 1

For a larger view of our floor plans, please check our website.





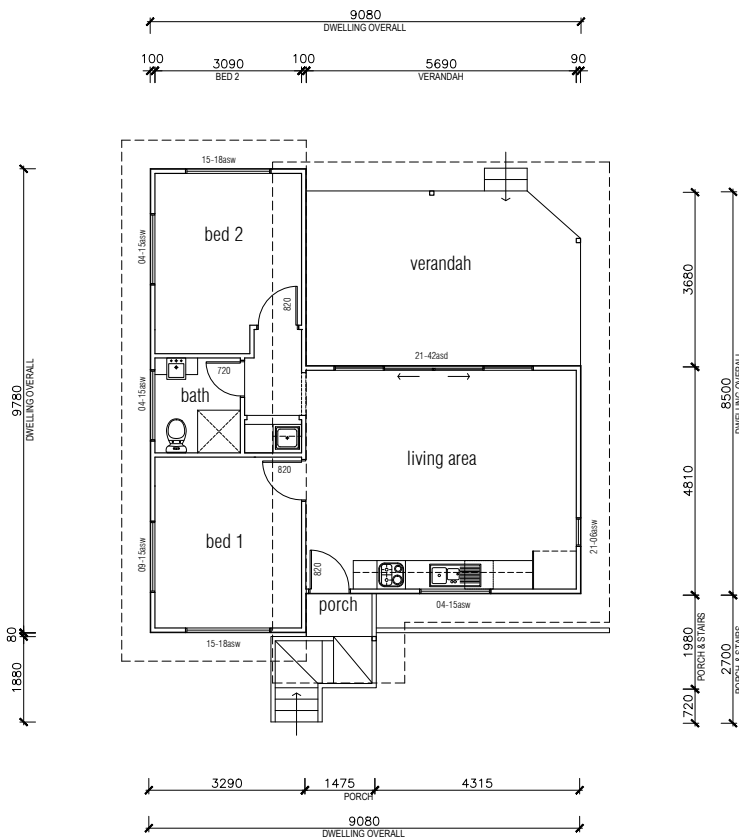

**iBUILD**<sup>TM</sup>  
Building Solutions



**KIT HOMES**

**MUDGE**

Ideal for singles or young couples, our compact Kit Homes Mudgee comes with a master bedroom and a small guest room. It has a big enough verandah where you can enjoy the sunset. Kingaroy is perfect for both privacy and socialising.

ENCLOSED	OTHER
60.02m <sup>2</sup>	21.94m <sup>2</sup>
<b>TOTAL 81.96m<sup>2</sup></b>	
 2  1  1	

For a larger view of our floor plans, please check our website.





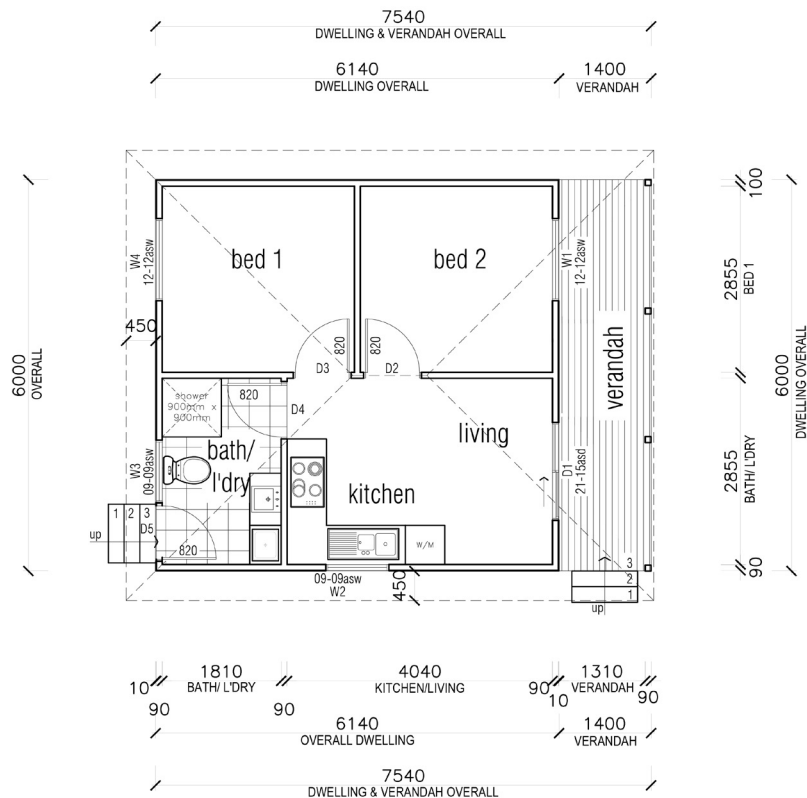

**iBUILD**<sup>TM</sup>  
Building Solutions



**KIT HOMES**

# HORSHAM

With two bedrooms and an open style kitchen and living area, comfort and simplistic style resonates throughout the Kit Homes Horsham.

ENCLOSED	OTHER
36.84m <sup>2</sup>	8.40m <sup>2</sup>
<b>TOTAL 45.24m<sup>2</sup></b>	
 2  1  1	

For a larger view of our floor plans, please check our website.





**KIT HOMES**

**BAYVIEW**

This modern-looking design with its skillion roof is neat and compact. Kit homes Bayview is perfectly suited for a retired couple. It can be used for a vacation/holiday home due to its features. The snug deck leading off the living area is ideal for alfresco dining.



ENCLOSED	OTHER
71.48m <sup>2</sup>	12.72m <sup>2</sup>

**TOTAL 84.20m<sup>2</sup>**

 2
  1
  1

For a larger view of our floor plans, please check our website.



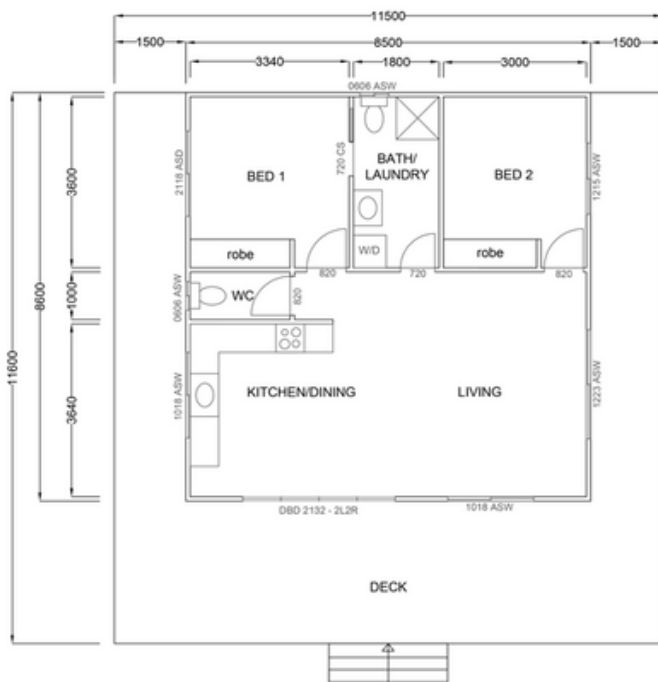

**KIT HOMES**

**EASTWOOD**

The Eastwood encapsulates a tropical feel that brings natural light to the open Kitchen and Living Room areas, with plenty of room for the family and entertaining guests.

ENCLOSED	OTHER
73.1m <sup>2</sup>	60.3m <sup>2</sup>
<b>TOTAL 133.4m<sup>2</sup></b>	
2	1  1

For a larger view of our floor plans, please check our website.





**KIT HOMES**

# HILLVIEW

The Kit Homes Hillview is perfect for any situation from those cosy nights around the TV in the lounge room to hosting your friends on its spacious verandah. For what ever you have in mind this 2 bedroom home is ready to make it a reality

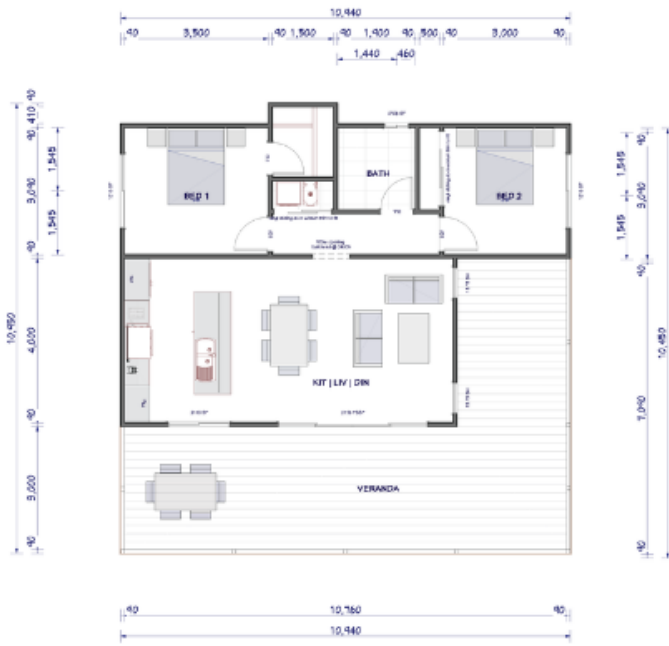

ENCLOSED	OTHER
<b>71.09 m<sup>2</sup></b>	<b>46.24 m<sup>2</sup></b>
<b>TOTAL 117.33 m<sup>2</sup></b>	
2	1
	1

For a larger view of our floor plans, please check our website.



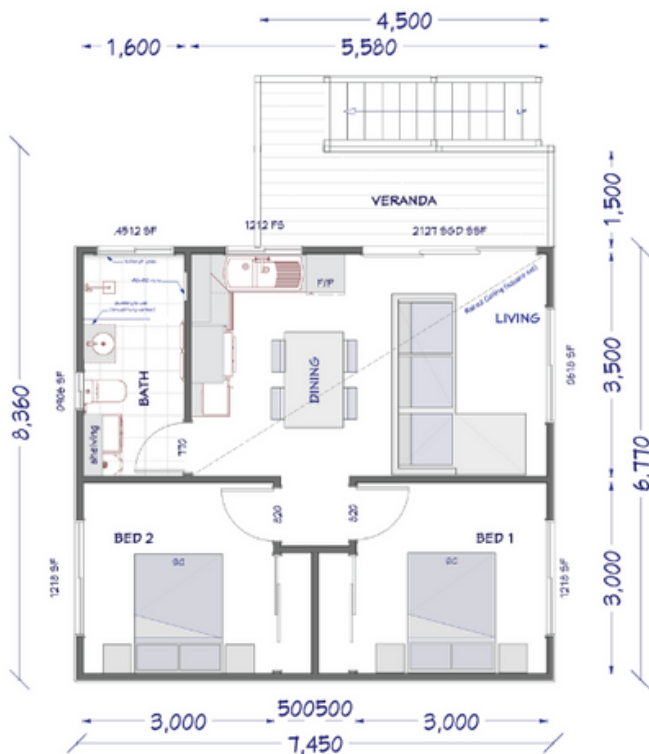

**KIT HOMES**

# HILLVIEW 44

The Kit Homes Hillview 44 is a 2-bedroom raised home that will make you feel like a king. Its spacious living room and high verandah will make this home feel like your castle.

ENCLOSED	OTHER
51.29m <sup>2</sup>	8.58m <sup>2</sup>
<b>TOTAL 59.87m<sup>2</sup></b>	
2	1
	1

For a larger view of our floor plans, please check our website.





**iBUILD**<sup>TM</sup>  
Building Solutions

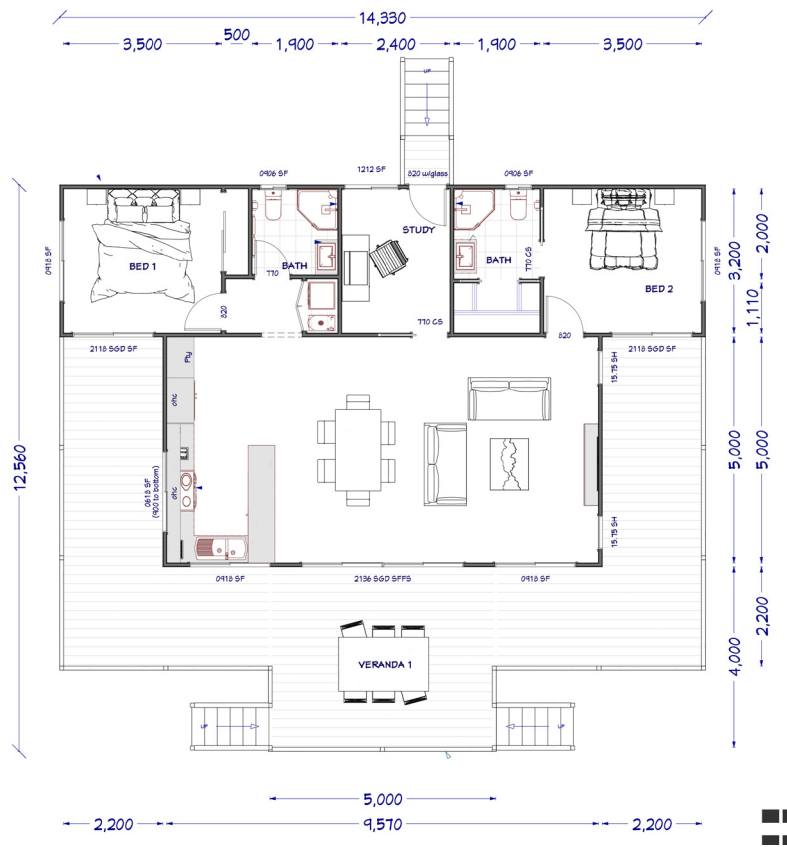

**KIT HOMES**

**BENDIGO**

Blending sophistication and relaxation, the Kit Homes Bendigo is the perfect oasis for new families. With a sweeping verandah, it brings the holiday to your doorstep.

ENCLOSED	OTHER
98.06m <sup>2</sup>	66.14m <sup>2</sup>
<b>TOTAL 166.20m<sup>2</sup></b>	

For a larger view of our floor plans, please check our website.







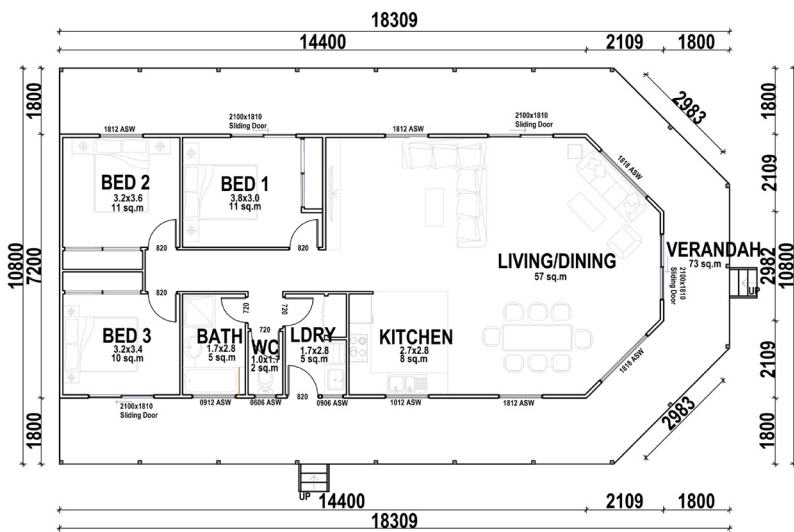

**KIT HOMES**

# BANKSIA

Embrace a welcoming yet a private compact home with our Banksia Kit Home, with a large Dining/Living and Kitchen area, the Banksia is perfect for both privacy and socialising.



ENCLOSED	OTHER
114.42m <sup>2</sup>	73.31m <sup>2</sup>
<b>TOTAL 187.73m<sup>2</sup></b>	
 3  1  1	

For a larger view of our floor plans, please check our website.



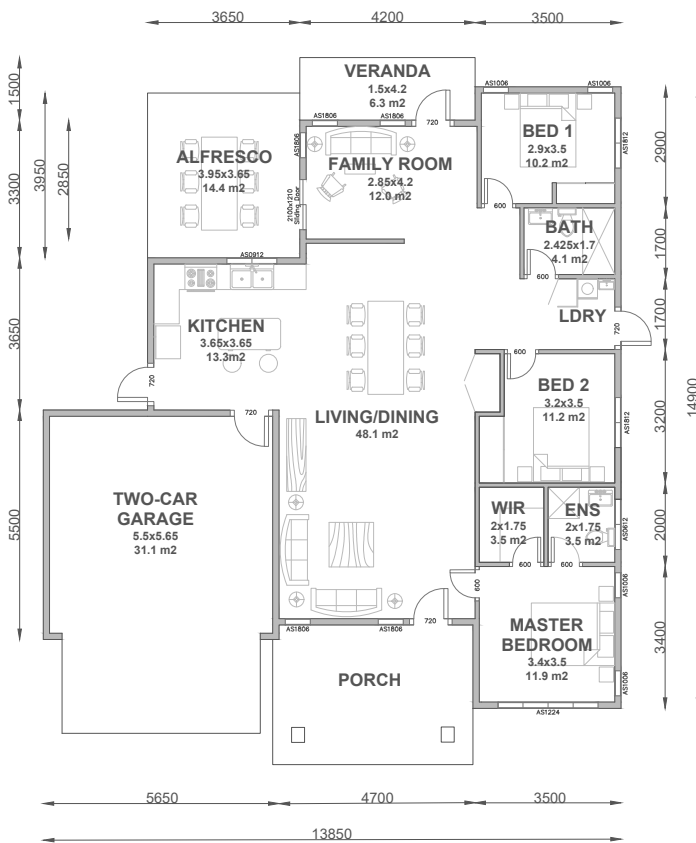

**KIT HOMES**

**SHEPPARTON**

Kit Homes Shepparton contains three spacious bedrooms including a master bedroom with ensuite. The stylish and modern home has also made entertaining a must with the inclusion of a spacious outdoor Alfresco entertaining area as well as a verandah.

ENCLOSED	OTHER
142.00m <sup>2</sup>	63.00m <sup>2</sup>
<b>TOTAL 205.00m<sup>2</sup></b>	
3	2
	1

For a larger view of our floor plans, please check our website.









**iBUILD**<sup>TM</sup>  
Building Solutions

**KIT HOMES**

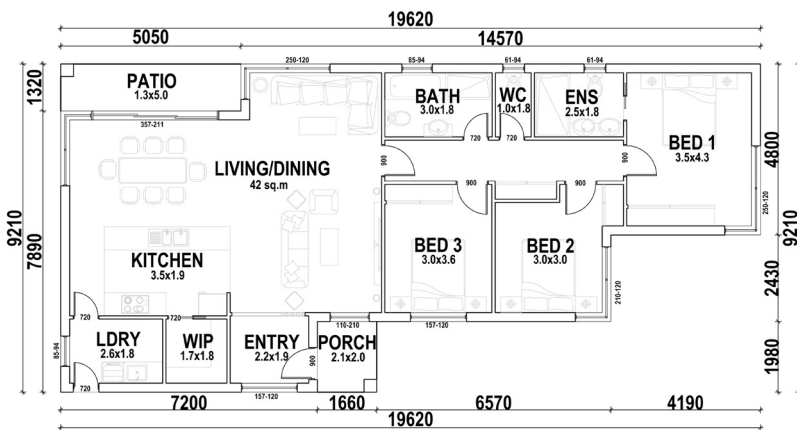
**GLADSTONE**

The Gladstone is a traditional but stylish kit home which includes everything a family needs. The 3 bedroom kit comes equipped with an open floor plan, outdoor patio, an ensuite in the master bedroom and two separate living areas allowing plenty of room to entertain guests.



ENCLOSED	OTHER
138.51m <sup>2</sup>	10.70m <sup>2</sup>
<b>TOTAL 149.21m<sup>2</sup></b>	
 3	 2
	 1

For a larger view of our floor plans, please check our website.





**iBUILD**<sup>TM</sup>  
Building Solutions

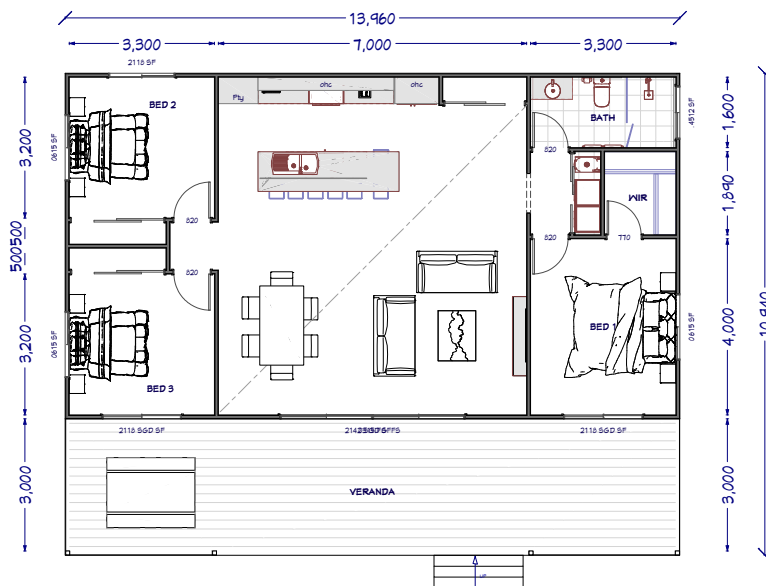

**KIT HOMES**

**BUNDABERG**

The Bundaberg has been impeccably crafted with a compact design to showcase an expansive space. The open plan living area and modern verandah which stretches across the length of the skillion roof is sure to bring your daydream to life.

ENCLOSED	OTHER
109.00m <sup>2</sup>	44.00m <sup>2</sup>
<b>TOTAL 153.00m<sup>2</sup></b>	
3	1  1

For a larger view of our floor plans, please check our website.





**KIT HOMES**

# PENRITH

Our cosy Penrith Kit Home comes with a comfortable sized living area. Perfect place for the family to come together after a long day. Enjoy the snug atmosphere of Penrith with our calming alfresco area.



ENCLOSED	OTHER
106.00m <sup>2</sup>	16.00m <sup>2</sup>
<b>TOTAL 122.00m<sup>2</sup></b>	
3	1  1

For a larger view of our floor plans, please check our website.



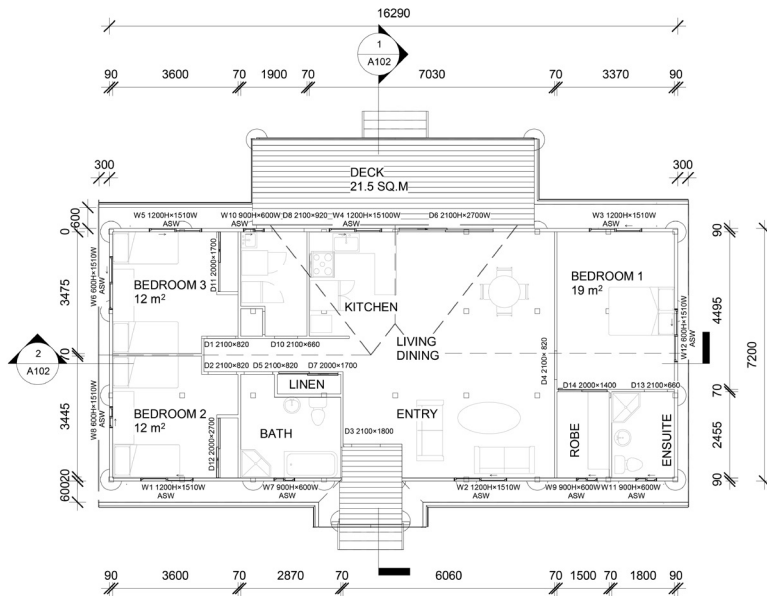
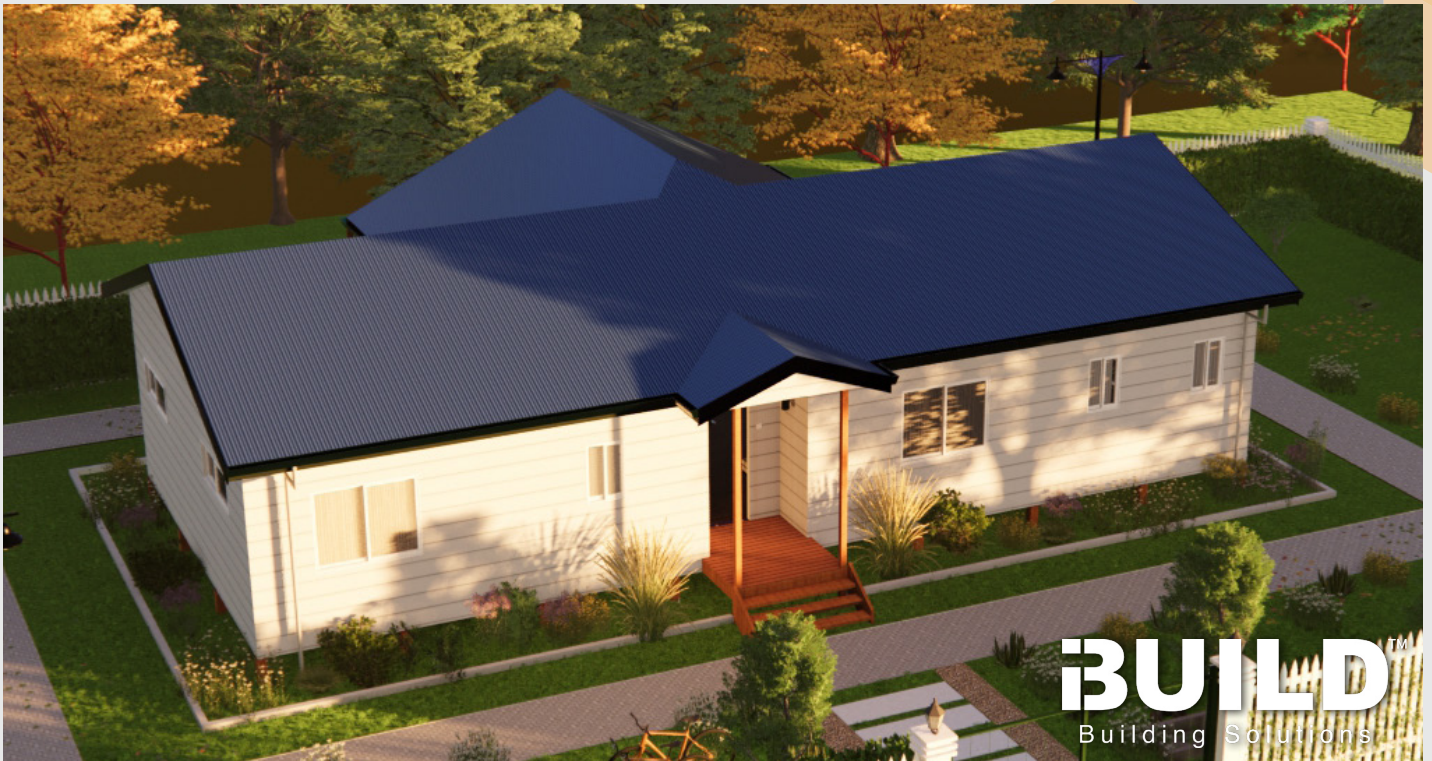



**KIT HOMES**

**LISMORE**

Practicality meets affordability. With an open plan living area and enough privacy for the bedrooms, the whole family can be in harmony with the Kit Homes Lismore.

ENCLOSED	OTHER
116.20m <sup>2</sup>	25.49m <sup>2</sup>
<b>TOTAL 141.69m<sup>2</sup></b>	
 3  2  1	

For a larger view of our floor plans, please check our website.





**iBUILD**<sup>TM</sup>  
Building Solutions



**KIT HOMES**

**WODONGA**

Enjoy life with our compact yet spacious Wodonga Kit home. With 3 bedrooms and a large living room this home is perfect for families wanting to socialize or just have the entire place to themselves. The impressive verandah gives you the delight of getting lost in nature at the comfort of your own home.

ENCLOSED	OTHER
95.14m <sup>2</sup>	25.56m <sup>2</sup>
<b>TOTAL 120.70m<sup>2</sup></b>	
3	1  1

For a larger view of our floor plans, please check our website.





**iBUILD**<sup>TM</sup>  
Building Solutions

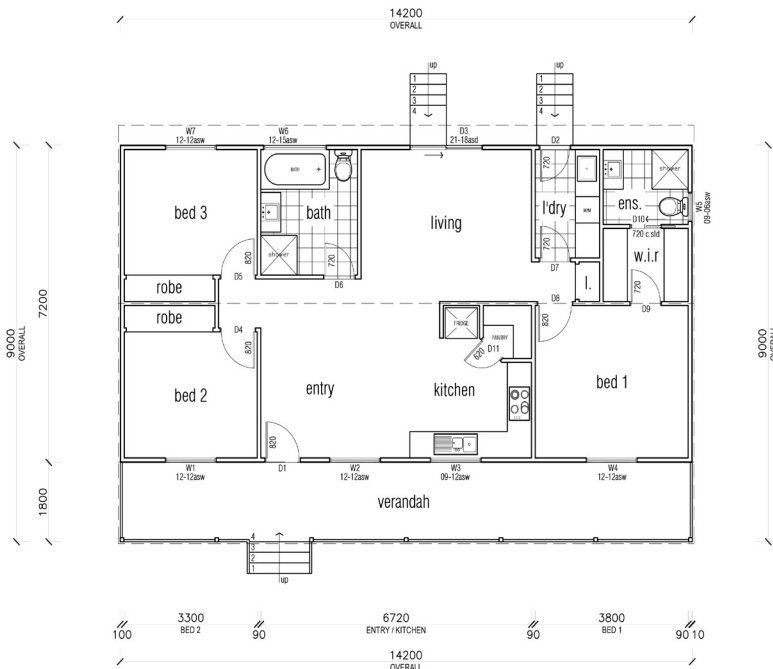

**KIT HOMES**

**WOLLONGONG**

With 3 spacious bedrooms and an outdoor verandah, the Kit Homes Wollongong is perfect for a family looking comfort and sanctuary.

ENCLOSED	OTHER
102.24m <sup>2</sup>	25.56m <sup>2</sup>
<b>TOTAL 127.80m<sup>2</sup></b>	
3	2
	1

For a larger view of our floor plans, please check our website.





**KIT HOMES**

**BUNBURY**

The Kit Homes Bunbury comes packed with beautiful aesthetics from the exterior right into the interior of the design. The dual section verandah and an open plan kitchen & living area are sure to entertain everyone.



ENCLOSED	OTHER
97.00m <sup>2</sup>	31.00m <sup>2</sup>
<b>TOTAL 128.00m<sup>2</sup></b>	
3	1
	1

For a larger view of our floor plans, please check our website.



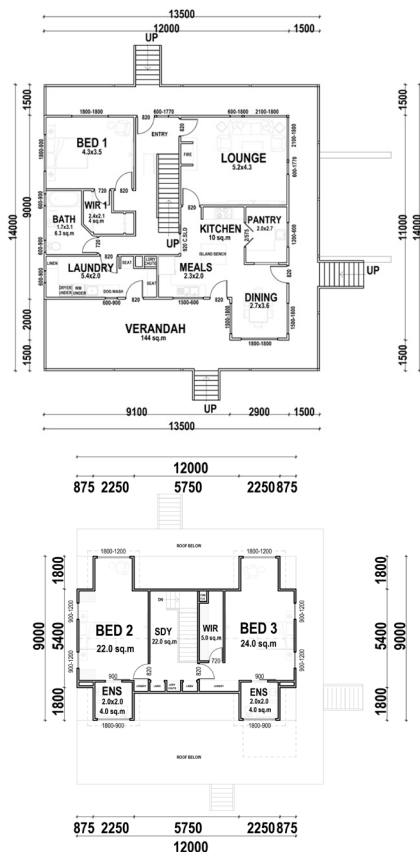

**KIT HOMES**

**GRANDVIEW**

Embrace your stylish and classical side of life with the Grandview. This stunning double storey home is aesthetically pleasing with an amazing verandah and large butler's pantry.

ENCLOSED	OTHER
196.58m <sup>2</sup>	75.20m <sup>2</sup>
<b>TOTAL 271.78m<sup>2</sup></b>	
3+	3  1

For a larger view of our floor plans, please check our website.







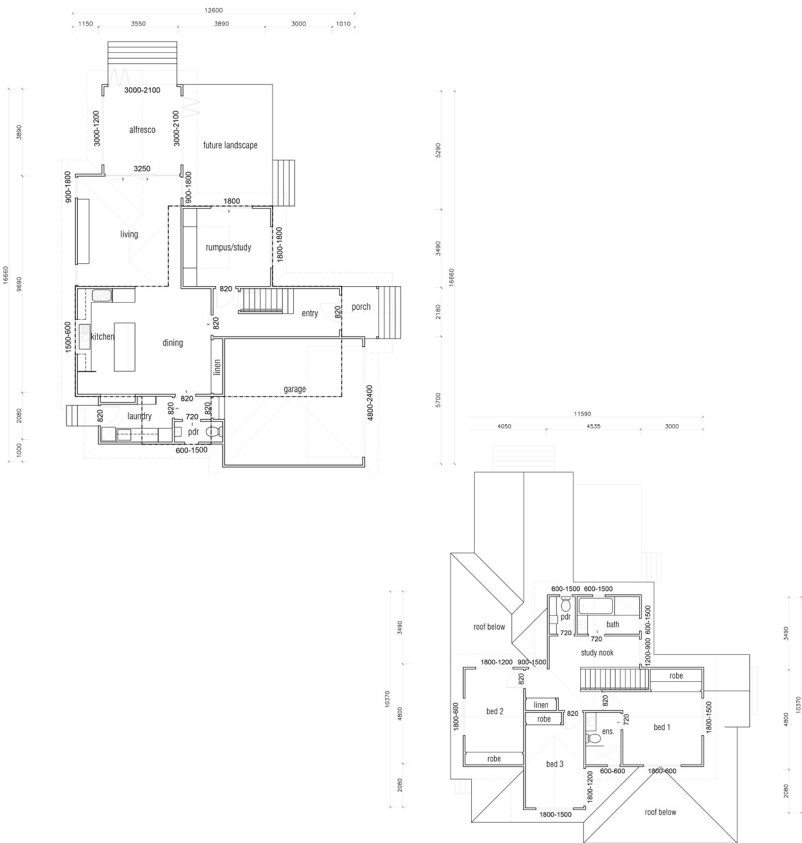

**KIT HOMES**

**NOWRA**

The modern and stylish Kit Homes Nowra is equipped with 3 bedrooms, a lovely alfresco and has access to all amenities. Perfect for families who want a hint of luxury.



ENCLOSED	OTHER
202.77m <sup>2</sup>	17.32m <sup>2</sup>
<b>TOTAL 220.09m<sup>2</sup></b>	
 3+  4  1	

For a larger view of our floor plans, please check our website.





**KIT HOMES**

**TOWNSVILLE**

The luxurious Kit Homes Townsville is the exquisite option for families or a groups offering amazing views with two separate outdoor areas. This space provides the opportunity to come together or take a moment away to relax.

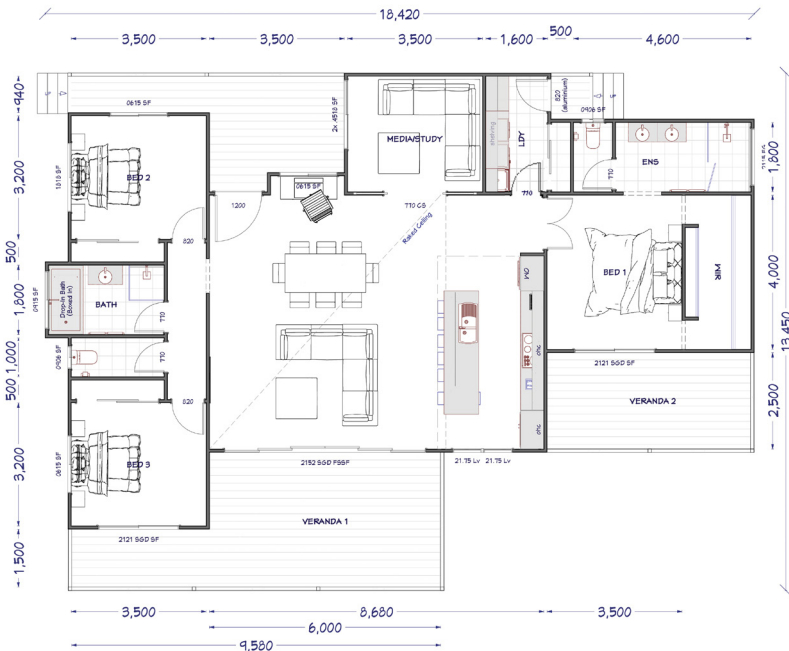

ENCLOSED	OTHER
137.78m <sup>2</sup>	69.89m <sup>2</sup>
<b>TOTAL 207.67m<sup>2</sup></b>	

For a larger view of our floor plans, please check our website.





**KIT HOMES**

# Townsville 44

The Kit Homes Townsville 44 provides the perfect sanctuary for a family to come together. This sleek modern designed house offers a sophisticated lifestyle with formal/informal living.

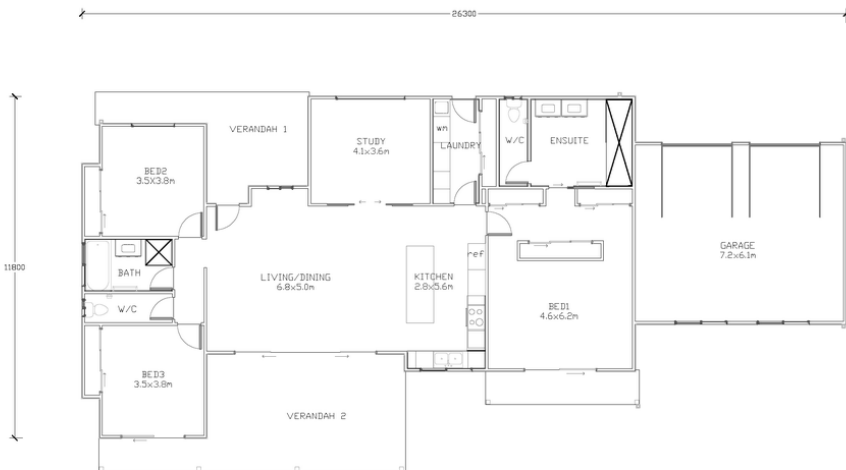

ENCLOSED	OTHER
<b>221.3 m<sup>2</sup></b>	<b>50.4 m<sup>2</sup></b>
<b>TOTAL 271.7 m<sup>2</sup></b>	
3+	1+  1

For a larger view of our floor plans, please check our website.





**KIT HOMES**

**TOOWOOMBA**

Build your dream home without compromising on space! The Toowoomba kit home offers a grand 4 bedrooms and a separate family area for your growing family. Enjoy the view from the living area which opens onto the verandah as you look out to the landscape that surrounds you.



ENCLOSED	OTHER
134.00m <sup>2</sup>	20.00m <sup>2</sup>
<b>TOTAL 154.00m<sup>2</sup></b>	
4	2  1

For a larger view of our floor plans, please check our website.





**KIT HOMES**

# MAYBANK

The sweeping verandah completes the styl-  
ish Maybank. The dining area opens onto  
the rear verandah making it ideal for alfres-  
co dining, while the living area opens to the  
verandah at the front. You can sit outdoors  
in any aspect with this home, and enjoy the  
winter sun, or summer shade.

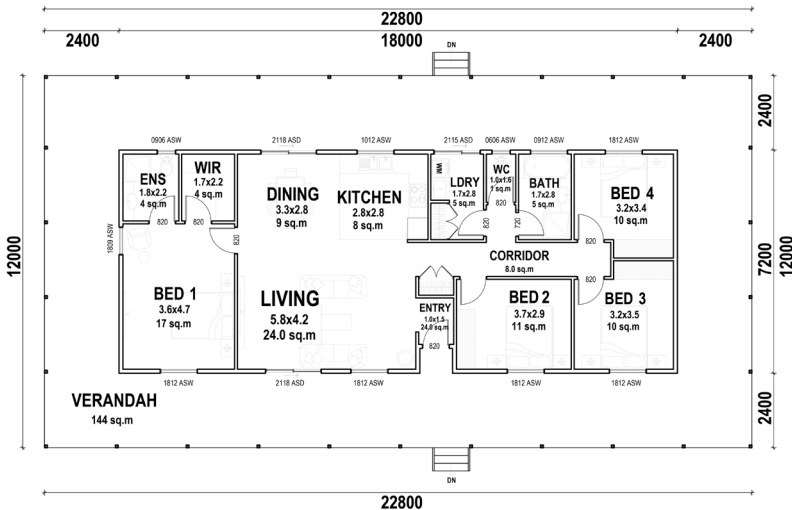

ENCLOSED	OTHER
129.60m <sup>2</sup>	144.00m <sup>2</sup>
<b>TOTAL 273.60m<sup>2</sup></b>	

For a larger view of our floor plans, please check our website.



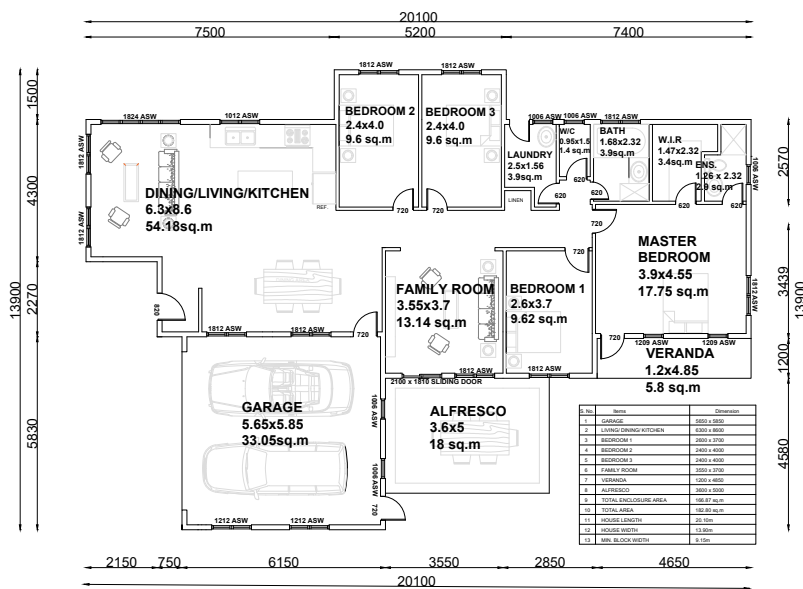



**KIT HOMES**

**BALLARAT**

This attractive family home with an alfresco at the back lends itself to easy family living. The internal access from the double garage will keep you dry on the wettest days as you return home. With three large bedrooms and a master ensuite, this modern Ballarat offers you both comfort and elegance.

ENCLOSED	OTHER
<b>158.98m<sup>2</sup></b>	<b>23.82m<sup>2</sup></b>
<b>TOTAL 182.80m<sup>2</sup></b>	
 4	 2
	 1

For a larger view of our floor plans, please check our website.





**iBUILD**<sup>TM</sup>  
Building Solutions

**KIT HOMES**

**ROCKHAMPTON**

This modern 4-bedroom kit homes Rockhampton includes a master ensuite and features separate living and family areas, with easy access to all amenities including an alfresco, while the entry from the double garage means that you can keep dry from your car to inside your dream home.

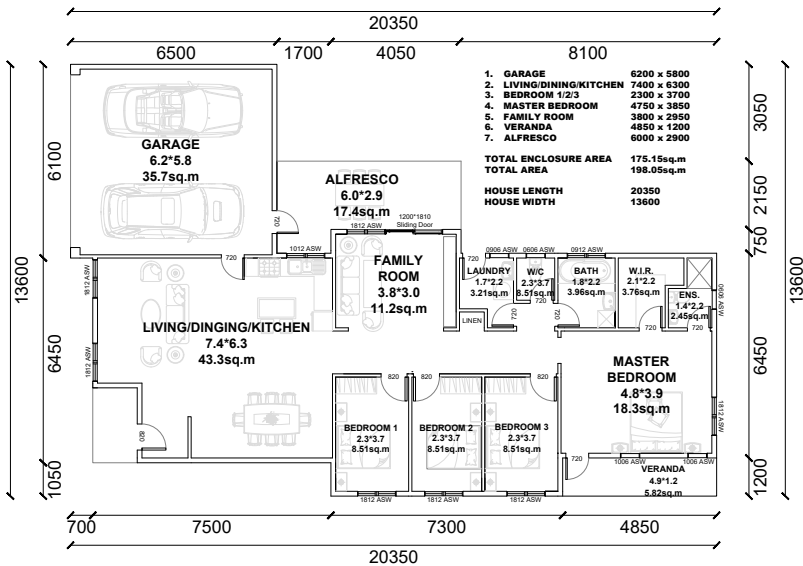

ENCLOSED	OTHER
<b>151.58m<sup>2</sup></b>	<b>23.22m<sup>2</sup></b>
<b>TOTAL 174.80m<sup>2</sup></b>	
4	2
	1

For a larger view of our floor plans, please check our website.



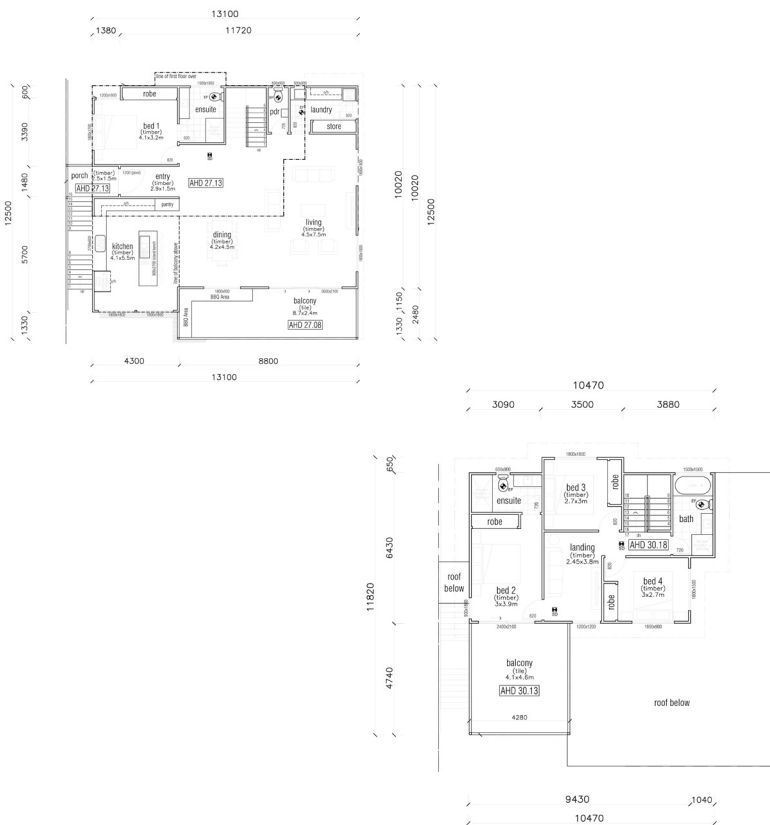

**KIT HOMES**

**VALLEY HEIGHTS**

The Valley Heights reigns supreme. The modern lines of this magnificent home enable you to make the most of the view. With balconies on both levels, this home will look great in any surroundings.

ENCLOSED	OTHER
204.82m <sup>2</sup>	50.08m <sup>2</sup>
<b>TOTAL 254.90m<sup>2</sup></b>	
4	2
	1

For a larger view of our floor plans, please check our website.



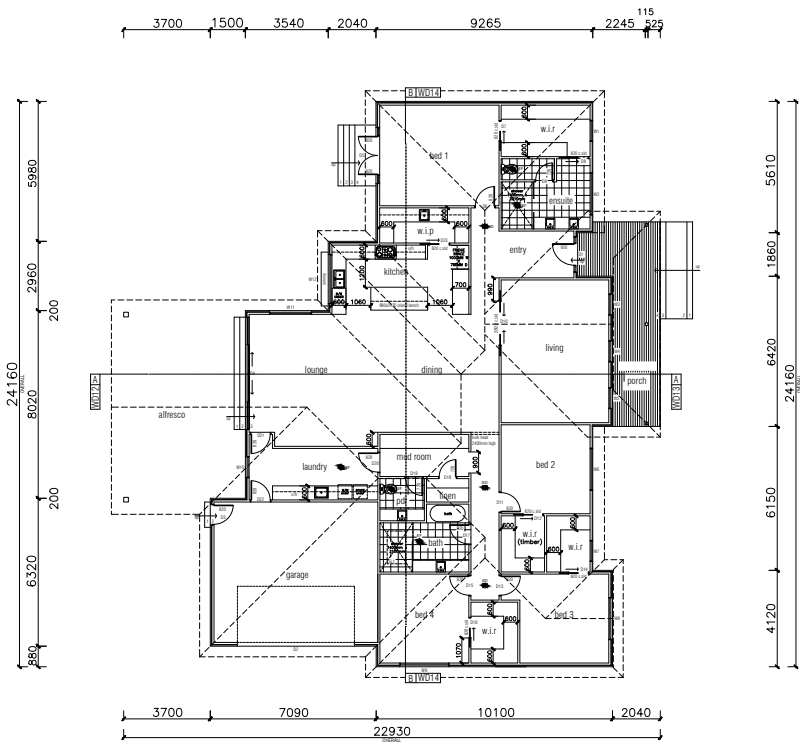

**KIT HOMES**

**SPRINGWOOD**

Grand country living with a modern and sophisticated touch. The Kit Homes Springwood provides an extensive layout for growing families looking for their own space.

ENCLOSED	OTHER
327.44m <sup>2</sup>	62.88m <sup>2</sup>

**TOTAL 390.32m<sup>2</sup>**

 4
  2
  1

For a larger view of our floor plans, please check our website.



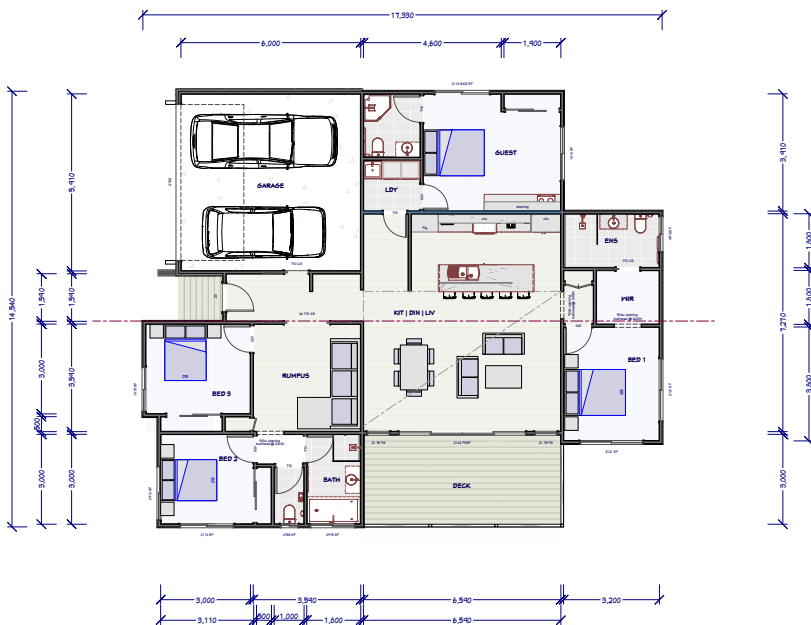

**KIT HOMES**

**NEWCASTLE**

The attractive exterior of the kit homes Newcastle exhibits a modern and sophisticated look. The floor plan offers great living areas for all family members so that everyone feels like they get their own space.

ENCLOSED	OTHER
196.50m <sup>2</sup>	64.00m <sup>2</sup>
<b>TOTAL 260.50m<sup>2</sup></b>	
4	3
	1

For a larger view of our floor plans, please check our website.



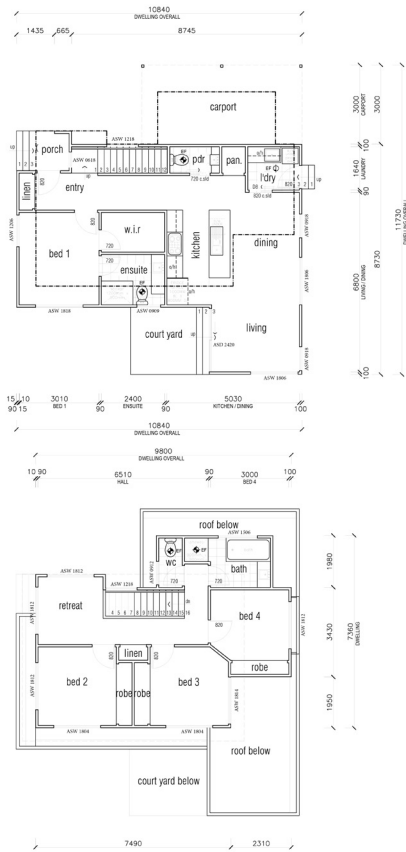

**KIT HOMES**

**HUNTER VALLEY**

Modern and sophisticated appeal is present with the Kit Homes Hunter Valley. The roomy townhouse that accommodates many different lifestyles.

ENCLOSED	OTHER
147.41m <sup>2</sup>	9.89m <sup>2</sup>
<b>TOTAL 157.30m<sup>2</sup></b>	
4	3
	1

For a larger view of our floor plans, please check our website.





**KIT HOMES**

# SEACREST

With its commanding panoramic view from the large living area at the front and rear, the Seacrest is the perfect home for watching amazing sunsets, family living and entertaining.

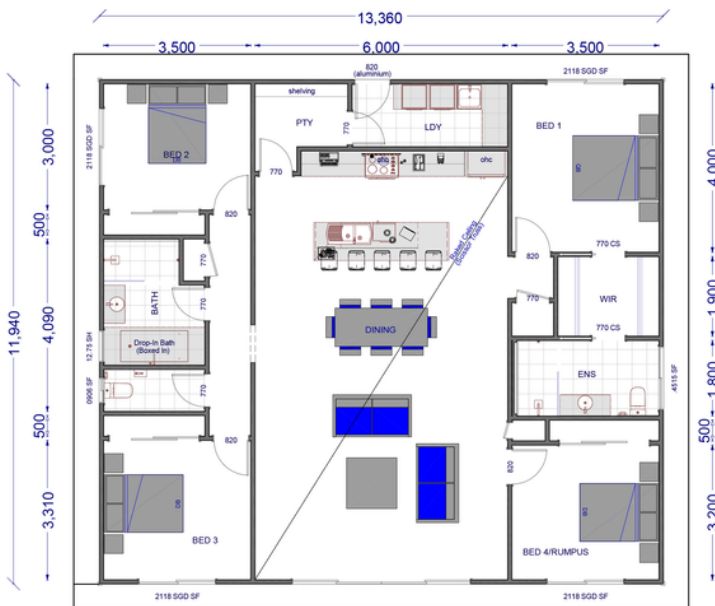

ENCLOSED	OTHER
160.00 m <sup>2</sup>	0.00 m <sup>2</sup>
<b>TOTAL 160.00 m<sup>2</sup></b>	
4	2
	1

For a larger view of our floor plans, please check our website.





**KIT HOMES**

# Port Macquarie

This Kit Homes Port Macquarie is an exquisite double-story home with everything you and your family need or want in your dream home.

ENCLOSED	OTHER
171 m <sup>2</sup>	51.2 m <sup>2</sup>
<b>TOTAL 222.2 m<sup>2</sup></b>	
4	2+  1

For a larger view of our floor plans, please check our website.



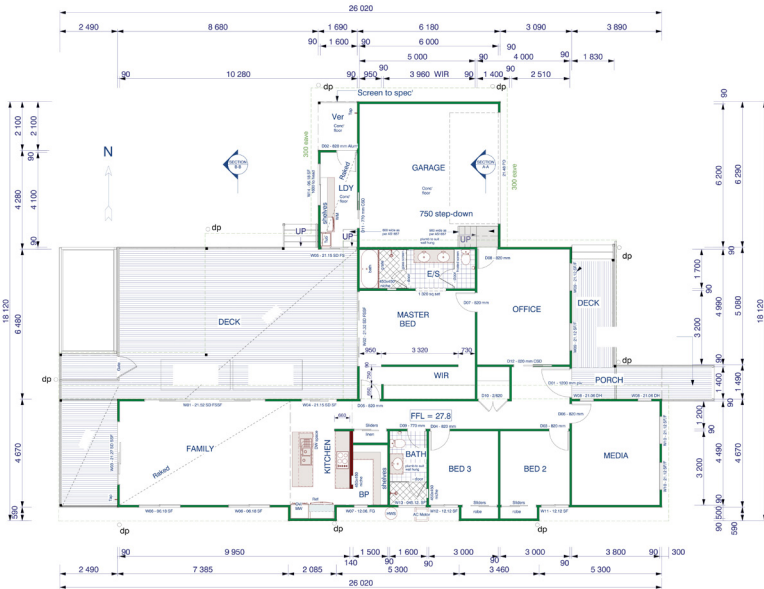

**KIT HOMES**

**DUBBO**

The spacious Dubbo offers a generously sized family area accompanied by a media room for all your entertainment needs. With a large deck space and 2 porches making it the perfect space to wind down.

ENCLOSED	OTHER
219.80m <sup>2</sup>	106.02m <sup>2</sup>
<b>TOTAL 325.82m<sup>2</sup></b>	

For a larger view of our floor plans, please check our website.







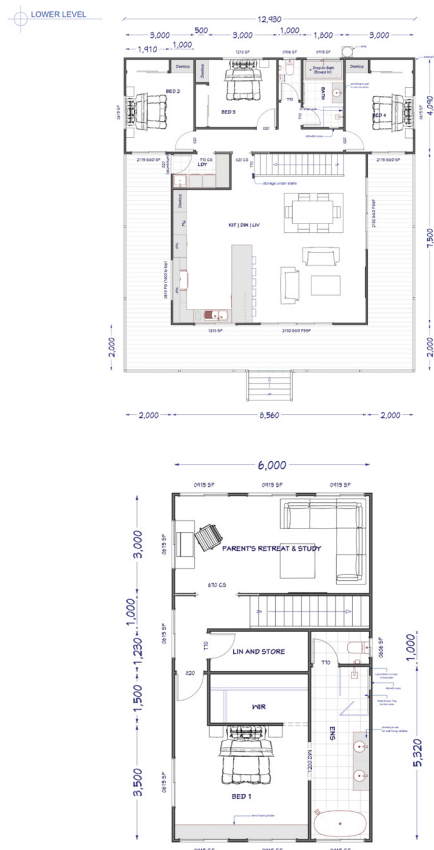

**KIT HOMES**

**CENTRAL COAST**

The spacious, double storey Kit Homes Central Coast provides the traditional appeal of a country-style rural home with the interior qualities of a contemporary and modern estate.

ENCLOSED	OTHER
183.00m <sup>2</sup>	59.00m <sup>2</sup>
<b>TOTAL 242.00m<sup>2</sup></b>	

For a larger view of our floor plans, please check our website.







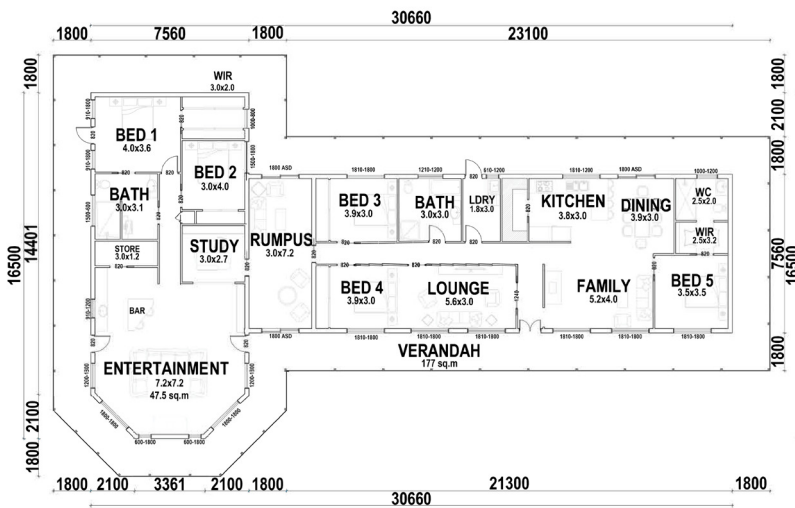

**KIT HOMES**

**WAGGAWAGGA**

The modern and contemporary Kit Home Wagga Wagga includes five bedrooms, separate living and family areas and easy access to all amenities such as the bar. With a hint of luxury, this kit home is for you!



ENCLOSED	OTHER
308.58m <sup>2</sup>	181.93m <sup>2</sup>
<b>TOTAL 490.51m<sup>2</sup></b>	
 5  3  1	

For a larger view of our floor plans, please check our website.





**KIT HOMES**

**ROYALROSE**

The Royal Rose is a five bedroom retreat like no other giving you a place where you can really feel at home. With five bedrooms you can make this space your own.

ENCLOSED	OTHER
321.55m <sup>2</sup>	15.97m <sup>2</sup>
<b>TOTAL 337.52m<sup>2</sup></b>	
5+	3
	1

For a larger view of our floor plans, please check our website.



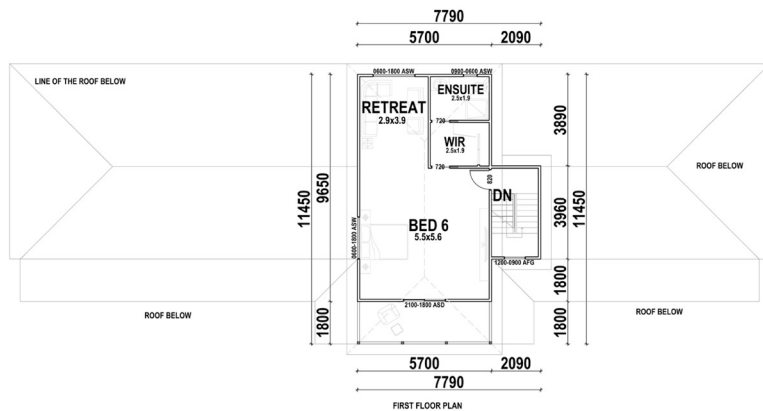
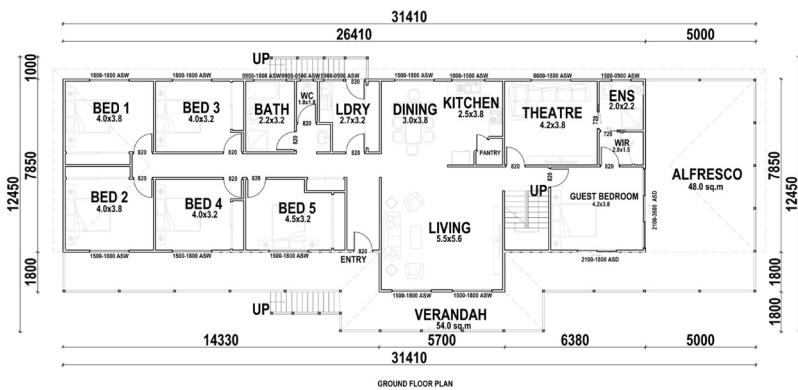

**KIT HOMES**

**GOLD COAST**

The grandeur of the Gold Coast boasts 7 bedrooms, spacious living areas, a home theatre and two outdoor living areas, with a verandah and an alfresco. The Gold Coast emanates luxury and is perfect for large families.

ENCLOSED	OTHER
280.04m <sup>2</sup>	109.52m <sup>2</sup>
<b>TOTAL 390.56m<sup>2</sup></b>	

For a larger view of our floor plans, please check our website.