

Port Macquarie 4+ Bedroom / 241 m²

BUILD
Homes



HOUSE DESIGN - Port Macquarie

Port Macquarie 4+ Bedroom / 241 m²

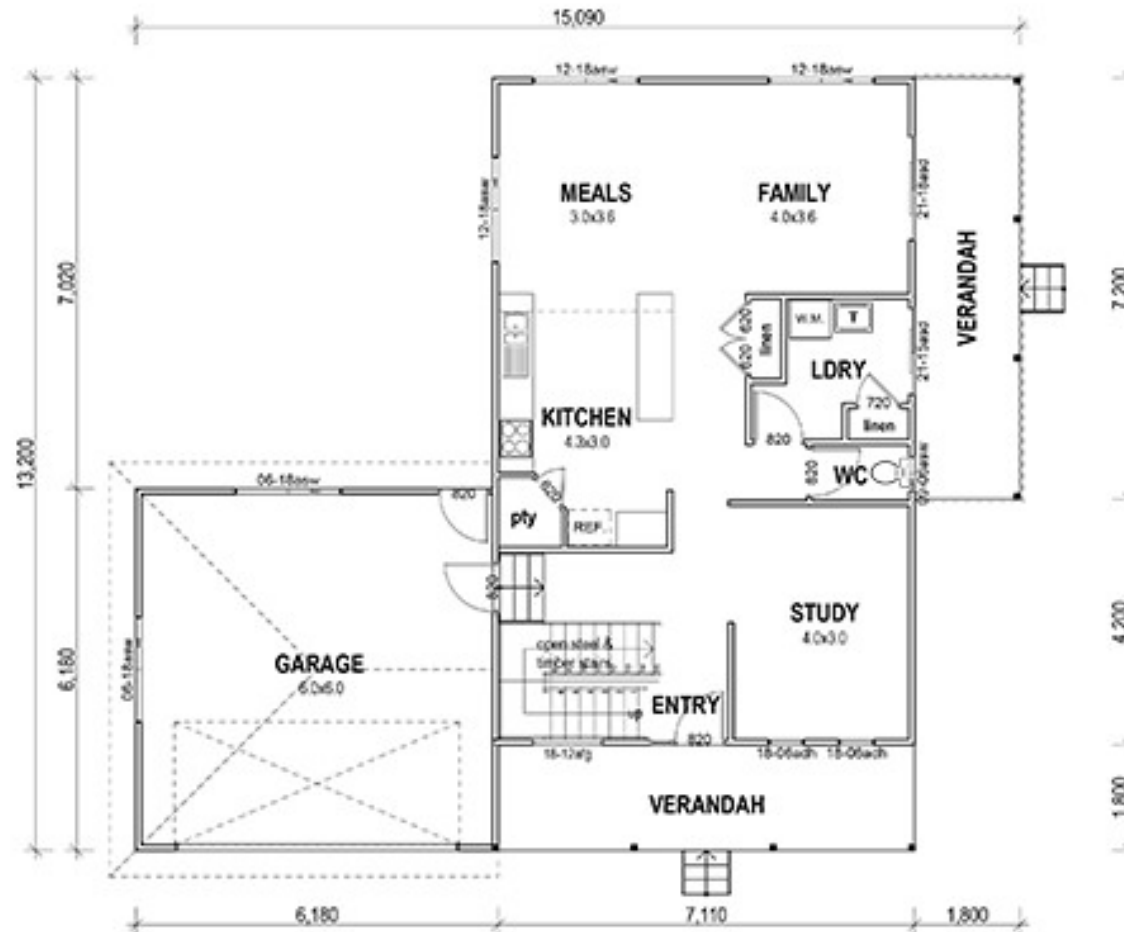

GROUND FLOOR PLAN

LOWER FLOOR AREAS:	
LIVING:	111.60 Sqm
VERANDAH:	25.76 Sqm
GARAGE:	37.80 Sqm
UPPER FLOOR AREAS:	
LIVING:	82.08 Sqm
VERANDAH:	12.96 Sqm
TOTAL AREA:	245.68 Sqm
	25,905 Sq

Thank you for your Attention !

For more information, please visit <http://www.i-build.com.au>
contact us on info@i-build.com.au



<http://i-build.com.au/>



<http://facebook.com/ibuildau/>



<http://pinterest.com/ibuildbuildings/>



<http://youtube.com/user/ibuildbuilding>



<http://plus.google.com/+I-buildAu/>