

Toowoomba 4 Bedroom / 250 m²

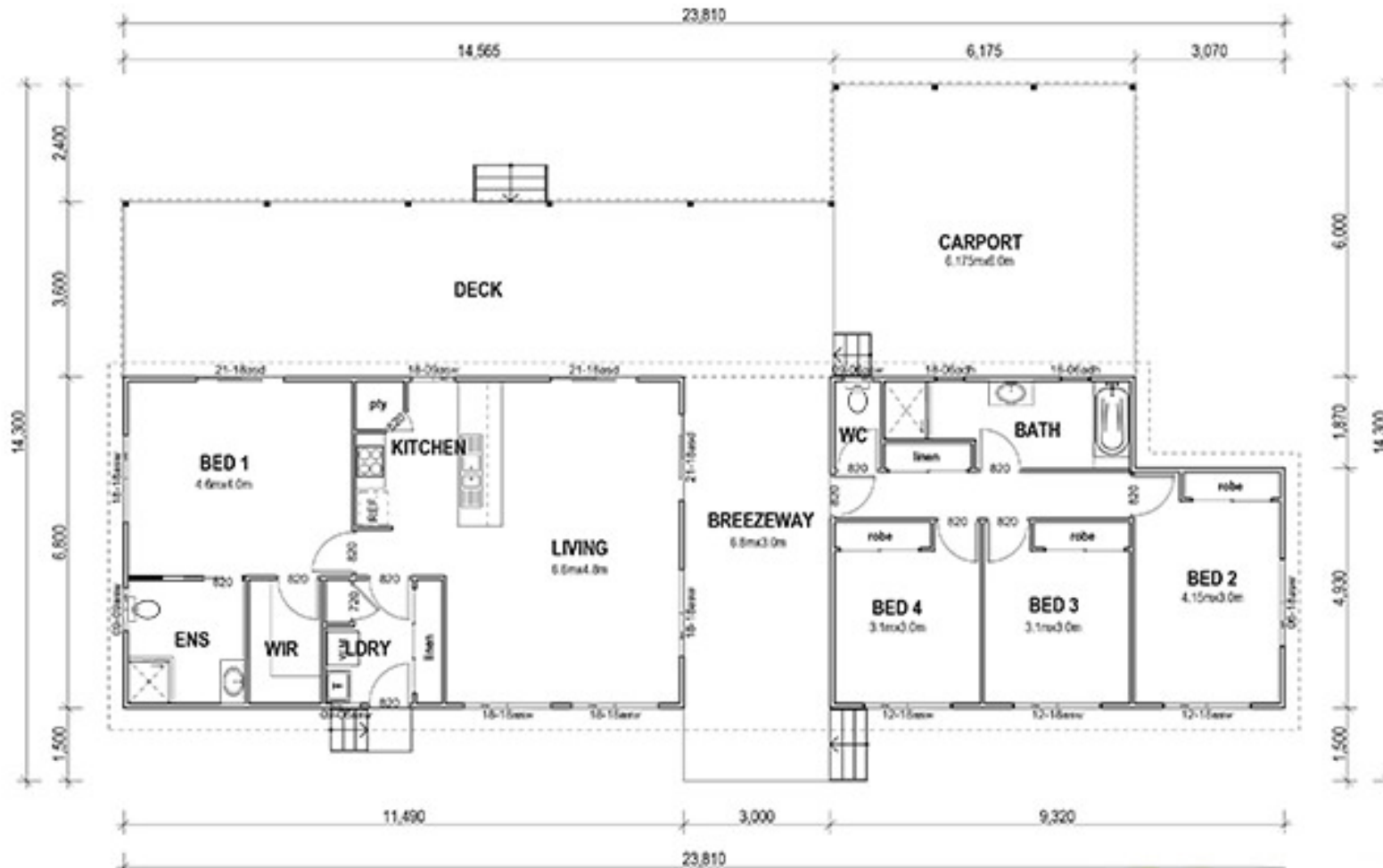

HOUSE DESIGN - Toowoomba

Toowoomba 4 Bedroom / 250 m²



FLOOR PLAN

LIVING AREA:	135.760 Sq.m
BREEZEWAY:	24.900 Sq.m
DECK:	52.430 Sq.m
CARPORT:	37.090 Sq.m
TOTAL AREA:	250.140 Sq.m
	28.920 Sq.

Thank you for your Attention !

For more information, please visit <http://www.i-build.com.au>
contact us on info@i-build.com.au



<http://i-build.com.au/>



<http://facebook.com/ibuildau/>



<http://pinterest.com/ibuildbuildings/>



<http://youtube.com/user/ibuildbuilding>



<http://plus.google.com/+I-buildAu/>